



CONTINENTAL CHAIN & RIGGING LTD

RIGGING CATALOG

TRUCK, PASSENGER, FORK LIFT, TRACTOR TIRE CHAINS, WIRE ROPE SLINGS,
BRIDLES, LOADING SLINGS, SYNTHETIC LIFTING SLINGS, POLYESTER ROUND
SLINGS, CORDURA ROUND SLINGS, EZ-LIFT ROUND SLINGS, SHACKLES, HOOKS,
TIE DOWN CHAINS, LOADBINDERS, LIFTING CHAIN GRADE 80, 100, 120

RIGGING CATALOG



YOUR SOLUTION PROVIDERS FOR ALL YOUR RIGGING NEEDS



HEAD OFFICE:

5303 - 75 ST NW

EDMONTON, AB T6E-5S5

PH# 780-437-2701

FAX# 780-430-9705

RED DEER:

102, 298 - BURNT PARK WAY

RED DEER, AB T4S-2L4

PH# 403-341-9661

FAX# 403-341-9698

TABLE OF CONTENTS

TIRE CHAINS - 3

WEB SLINGS - 27

ROUND SLINGS - 33

WIRE ROPE - 35

LIFTING CHAIN - 43

CARGO CONTROL - 46

TIRE CHAIN



TIRE CHAINS

CONTINENTAL CHAIN PROVIDES TIRE CHAINS FOR EVERY TIRE SIZE FROM SNOWBLOWER CHAINS TO SKIDDER TYPE CHAINS. CONTINENTAL TAKES PRIDE IN PROVIDING THE BEST QUALITY TIRE CHAINS IN THE MARKETPLACE.



TIRE CHAINS



TRYGG Nøsted Kjetting as is well known for its wide range of tire chains for various purposes. ****MUST PREFIT CHAINS BEFORE USE****

SUPER 2000 - (7mm - 9/32")

TRYGG tire chains are manufactured from ultimately alloyed steel which contain chrome, manganese, nickel and boron, and in some cases nickel and titanium. The chains are hardened to perfection. All tire chains are made of double steel. The outer layer is carbon rich for wear resistance and the core is manganese/chrome alloyed for toughness. All studs and lugs are oversized and made of boron alloyed steel to ensure the maximum core hardness

TIRE SIZE	SINGLES WITHOUT CAMS	SINGLES WITH CAMS	TRIPLES WITHOUT CAMS	TRIPLES WITH CAMS
8.25R15, 235/75R17.5, 235/85R16	TRY490063	TRY491063		
245X16, 245/60R19.5 31X11.50-15, 10X16.5, 245/85R16, 265/70R15	TRY490082	TRY491082		
265/70R22.5, 10X19.5, 255/70-22.5, 8.25X20, 9X22.5	TRY490165	TRY491165		
9,00-20_10-22,5	TRY490364	TRY491364		
10.00X20, 11.00X22.5, 275/80X22.5, 285/75X22.5, 285/80X22.5	TRY490374	TRY491374	TRY494374	TRY495374
10.00X22, 11.00X24.5, 295/75X24.5	TRY490375	TRY491375	TRY494375	TRY495375
11.00X20, 12X22.5, 295/80R22.5, 305/75R24.5, 315/75R22,5	TRY490384	TRY491384	TRY494384	TRY495384
12.00X20, 13X22.5	TRY490385	TRY491385	TRY494385	TRY495385
12.00X24	TRY490386	TRY491386	TRY494386	TRY495386
14.00X24, 385/95R25	TRY490408	TRY491408	TRY494408	TRY495408
13.50X20, 14.00X20	TRY490416	TRY491416	TRY494416	TRY495416
385/65R22.5	TRY490424	TRY491424	TRY494424	TRY495424
425/65R22.5	TRY490444	TRY491444	TRY494444	TRY495444
435/65R22.5, 445/65R22.5	TRY490446	TRY491446	TRY494446	TRY495446

STUDED TRUCK (5/16" - 8MM)

TIRE SIZE	SINGLES WITHOUT CAMS	SINGLES WITH CAMS	TRIPLES WITHOUT CAMS	TRIPLES WITH CAMS
10.00X20, 11RX22.5, 285/75-24.5	TRY460200	TRY460201	TRY464200	TRY464201
10.00X22, 11X24.5, 295/75X24.5	TRY460220	TRY460221	TRY464220	TRY464221
11.00X20, 12X22.5, 295/80X22.5	TRY460222	TRY460223	TRY462222	TRY464223
385/65X22.5		TRY457424		
12.00X20, 11.00X22, 12X24.5	TRY460230	TRY460231	TRY462222	TRY495386
12.00X24, 12.00X25	TRY460232	TRY464233	TRY464232	TRY464233
425/65X22.5		TRY457444		
435/65X22.5, 445/65X22.5	TRY460445	TRY460846	TRY454895	TRY457896

COMMON STEERING CHAINS

TIRE SIZE	SINGLES WITH CAMS (5/16"-8MM)	DOUBLE DUTY WITHOUT CAMS (5/16"-8MM)	S2000 (9/32" -7MM) DOUBLE DUTY
385/65X22.5	TRY457424	TRY452924	TRY492424
425/65X22.5	TRY457444	TRY452944	TRY492444
445/65X22.5	TRY457895	TRY452895	TRY492446

SUPER DUTY (3/8" - 9.5MM)

TIRE SIZE	SINGLES WITHOUT CAMS	SINGLES WITH CAMS	TRIPLES WITHOUT CAMS	TRIPLES WITH CAMS
10.00X22, 11RX24.5, 295/75-24.5	TRY460620	TRY460621	TRY464620	TRY464621
11.00X20, 12X22.5, 295/80X22.5	TRY460622	TRY460623	TRY466622	TRY464623
11.00X22, 12.00X20, 12X24.5	TRY460630	TRY460631	TRY464630	TRY464631
12.00X24	TRY460632	TRY460633	TRY464632	TRY464633
12.75X24, 13.00X24, 14.00X20	TRY460634	TRY460635	TRY464634	TRY464635
13.50X24, 14.00X24, 385/95X22.5	TRY460646	TRY460647	TRY464646	TRY464647

SCAN – TRAC

SCAN TRAC IS THE LIGHTEST CHAIN AVAILABE AND STILL MADE WITH 5MM ALLOY STEEL.
THE WEAR BARS GIVE EXCELLECT GRIP WHILE MAINTAINING DURABILTY.

TIRE SIZE	SINGLES	TRIPLES
8.75X16.5, 30X9.50X15, 205/75X17.5, 225/75X16	TRY477070	
7.50X16, 8.5X17.5, 9.50X16.5, 225/75X17.5, 235X16, 245/75X16	TRY477080	
10.00X20, 11X22.5, 295/75-24.5, 305/70X22.5, 315/70X22.5	TRY477100	TRY477101
10.00X22, 11.00X20, 11X24.5, 12R22.5, 295/80X22.5 315/80X22.5	TRY477110 TRY477112	TRY477111 TRY477113
385/65X22.5, 365/80X20, 14.5X20	TRY477320	TRY477720
425/65X22.5, 16.5X22.5	TRY477325	
445/65X22.5, 18X22.5	TRY477323	



NET LINK STUDDED

NET LINK IS A VERSATILE MULTI PURPOSE CHAIN FOR USE ON ALL TYPES OF HEAVY EQUIPMENT. PROVEN DOUBLE DIAMOND DESIGN WITH DOUBLE STUDS PROVIDE FULL TIRE WIDTH TRACTION. FULLY HARDENED AND ANNEALED ENSURES TROUBLE FREE PERFORMANCE IN ALL CONDITIONS AND TEMPERATURES.

TIRE SIZE	MATERIAL SIZE	DESCRIPTION	PART NUMBER
16.9 X 34	(1/2" - 13MM)	NET LINK STUDDED	TRY611252
16.9 X 38	(1/2" - 13MM)	NET LINK STUDDED	TRY611253
16.9 X 38	(5/8" - 16MM)	NET LINK STUDDED	TRY611353
18.4 X 30	(1/2" - 13MM)	NET LINK STUDDED	TRY611252
18.4 X 34	(1/2" - 13MM)	NET LINK STUDDED	TRY611253
18.4 X 34	(5/8" - 16MM)	NET LINK STUDDED	TRY611353
18.00 X 24/25	(1/2" - 13MM)	NET LINK STUDDED	TRY611257
18.00 X 24/25	(3/4" - 19MM)	NET LINK STUDDED	TRY611357
18.00 X 24/25 L5	(1/2" - 13MM)	NET LINK STUDDED	TRY611258
18.00 X 24/25 L5	(5/8" - 16MM)	NET LINK STUDDED	TRY611358
22/65 X 25	(1/2" - 13MM)	NET LINK STUDDED	TRY611276
22/65 X 25	(5/8" - 16MM)	NET LINK STUDDED	TRY611376
23.1 X 26	(1/2" - 13MM)	NET LINK STUDDED	TRY611265
23.1 X 26	(5/8" - 16MM)	NET LINK STUDDED	TRY611365
23.5 X 25 STD	(1/2" - 13MM)	NET LINK STUDDED	TRY611267
23.5 X 25 STD	(5/8" - 16MM)	NET LINK STUDDED	TRY611367
23.5 X 25 L5	(1/2" - 13MM)	NET LINK STUDDED	TRY611268
23.5 X 25 L5	(5/8" - 16MM)	NET LINK STUDDED	TRY611368
24.5 X 32	(5/8" - 16MM)	NET LINK STUDDED	TRY611366
24.5 X 32	(3/4" - 19MM)	NET LINK STUDDED	TRY611466
26.5 X 25 STD	(5/8" - 16MM)	NET LINK STUDDED	TRY611373
26.5 X 25 STD	(3/4" - 19MM)	NET LINK STUDDED	TRY611473
29.5 X 25 STD	(5/8" - 16MM)	NET LINK STUDDED	TRY611381
29.5 X 25 STD	(3/4" - 19MM)	NET LINK STUDDED	TRY611481
26.5 X 25 L5	(5/8" - 16MM)	NET LINK STUDDED	TRY611369
26.5 X 25 L5	(3/4" - 19MM)	NET LINK STUDDED	TRY611469
29.5 X 25 L5	(5/8" - 16MM)	NET LINK STUDDED	TRY611370
29.5 X 25 L5	(3/4" - 19MM)	NET LINK STUDDED	TRY611470
30.5 X 32 DD	(5/8" - 16MM)	NET LINK STUDDED	TRY611371
TRIPLE DIAMOND	(5/8" - 16MM)	NET LINK STUDDED	TRY611372
DOUBLE DIAMOND	(3/4" - 19MM)	NET LINK STUDDED	TRY611471

NET LINK STUDDED

TIRE SIZE	MATERIAL SIZE	DESCRIPTION	PART NUMBER
TRIPLE DIAMOND	(3/4" - 19MM)	NET LINK STUDDED	TRY611472
DOUBLE DIAMOND	(7/8" - 22MM)	NET LINK STUDDED	TRY611571
35.5 X 32	(3/4" - 19MM)	NET LINK STUDDED	TRY611482
35.5 X 32	(7/8" - 22MM)	NET LINK STUDDED	TRY611851
500/60 X 22.5	(1/2" - 13MM)	NET LINK STUDDED	TRY611228
500/50 X 22.5	(1/2" - 13MM)	NET LINK STUDDED	TRY611275
500/55 X 22.5	(1/2" - 13MM)	NET LINK STUDDED	TRY611242
500/55 X 26.5	(1/2" - 13MM)	NET LINK STUDDED	TRY611276
500/55 X 26.5	(5/8" - 16MM)	NET LINK STUDDED	TRY611376
600/65 X 34	(5/8" - 16MM)	NET LINK STUDDED	TRY611378
700/45 X 22.5	(1/2" - 13MM)	NET LINK STUDDED	TRY611204
700/50 X 26.5	(1/2" - 13MM)	NET LINK STUDDED	TRY611261
700/50 X 26.5	(5/8" - 16MM)	NET LINK STUDDED	TRY611361
700/55 X 34	(5/8" - 16MM)	NET LINK STUDDED	TRY611364
700/55 X 34	(3/4" - 19MM)	NET LINK STUDDED	TRY611465
73/44.00 X 32	(5/8" - 16MM)	NET LINK STUDDED	TRY611385
Triple Diamond	(5/8" - 16MM)	NET LINK STUDDED	TRY611389
Double Diamond	(3/4" - 19MM)	NET LINK STUDDED	TRY611445
Triple Diamond	(3/4" - 19MM)	NET LINK STUDDED	TRY611489
Double Diamond	(7/8" - 22MM)	NET LINK STUDDED	TRY611585
67/34.00 X 26	(5/8" - 16MM)	NET LINK STUDDED	TRY611387
68/50.00 X 32 TD	(3/4" - 19MM)	NET LINK STUDDED	TRY611496
Double Diamond	(7/8" - 22MM)	NET LINK STUDDED	TRY611596
66X43.00X25/26 TD	(5/8" - 16MM)	NET LINK STUDDED	TRY611389
TRIPLE DIAMOND	(3/4" - 19MM)	NET LINK STUDDED	TRY611451



SMT TIRE CHAINS

A VERSATILE TRACTION CHAIN FOR SNOW CLEARING, FORESTRY AND CONSTRUCTION. EXCELLENT GRIP, SMOOTH RIDE AND VIRTUALLY TROUBLE FREE PERFORMANCE. SMT PATTERN HOLDS THE CHAIN ON THE TOP OF THE TIRE LUGS, KEEPING THE STUDS IN CONSTANT CONTACT WITH THE TERRAIN. WITH OVERSIZED STUDS THIS INCREASES GRIP AND LAST LONGER.

TIRE SIZE	MATERIAL SIZE	DESCRIPTION	PART NUMBER
14.00 X 24	(3/8" - 9.5MM)	SMT (SINGLE DIAMOND PATTERN)	TRY603780
14.00 X 24	(1/2" - 13MM)	SMT (SINGLE DIAMOND PATTERN)	TRY605780
16.00 X 24	(1/2" - 13MM)	SMT (SINGLE DIAMOND PATTERN)	TRY605781
16.00 X 24	(5/8" - 16MM)	SMT (SINGLE DIAMOND PATTERN)	TRY606782
18.00 X 24	(5/8" - 16MM)	SMT (SINGLE DIAMOND PATTERN)	TRY606792
18.00 X 24	(3/4" - 19MM)	SMT (SINGLE DIAMOND PATTERN)	TRY608792
15.5 X 25	(3/8" - 9.5MM)	SMT (SINGLE DIAMOND PATTERN)	TRY603760
15.5 X 25	(1/2" - 13MM)	SMT (SINGLE DIAMOND PATTERN)	TRY605760
17.5 X 25	(3/8" - 9.5MM)	SMT (SINGLE DIAMOND PATTERN)	TRY603762
17.5 X 25	(1/2" - 13MM)	SMT (SINGLE DIAMOND PATTERN)	TRY605762
17.5 X 25	(5/8" - 16MM)	SMT (SINGLE DIAMOND PATTERN)	TRY606762
20.5 X 25	(3/8" - 9.5MM)	SMT (SINGLE DIAMOND PATTERN)	TRY603764
20.5 X 25	(1/2" - 13MM)	SMT (SINGLE DIAMOND PATTERN)	TRY605764
20.5 X 25	(5/8" - 16MM)	SMT (SINGLE DIAMOND PATTERN)	TRY606764
20.5 X 25 L5	(1/2" - 13MM)	SMT (SINGLE DIAMOND PATTERN)	TRY605765
20.5 X 25 L5	(5/8" - 16MM)	SMT (SINGLE DIAMOND PATTERN)	TRY606765
23.5 X 25	(5/8" - 16MM)	SMT (SINGLE DIAMOND PATTERN)	TRY606766
23.5 X 25	(3/4" - 19MM)	SMT (SINGLE DIAMOND PATTERN)	TRY608766
23.5 X 25 L5	(3/4" - 19MM)	SMT (SINGLE DIAMOND PATTERN)	TRY608767
26.5 X 25	(3/4" - 19MM)	SMT (SINGLE DIAMOND PATTERN)	TRY608768
26.5 X 25 L5	(3/4" - 19MM)	SMT (SINGLE DIAMOND PATTERN)	TRY608769



FRAM STUDDED TRUCK CHAINS



FRAM CARRIES THE TRADITION OF MORE THAN 100 YEARS OF TIRE CHAIN PRODUCTION IN NORWAY. NORWEGIAN DESIGN AND SPECIFICATIONS. BUILT ON EUROPEAN MACHINERY, QUALITY CONTROLLED. BUILT WITH 7MM (9/32") AND 8MM (5/16") OVERSIZED STUDS.

TIRE SIZE	SINGLES WITH CAMS (7MM-9/32")	SINGLES WITH CAMS (8MM-5/16")	TRIPLES WITH CAMS (7MM-9/32")	TRIPLES WITH CAMS (8MM-5/16")
10.00X20, 11.00X22.5, 275/80X22.5, 285/75X22.5, 285/80X22.5	TRY491374F	TRY460201F	TRY495374F	TRY464201F
10.00X22, 11X24.5, 295/75X24.5	TRY491375F	TRY460221F	TRY495375F	TRY464221F

FRAM STUDDED SMT CHAINS



TIRE SIZE	MATERIAL SIZE	DESCRIPTION	PART NUMBER
16.00 X 24/25	(7/16" - 11MM)	SMT (SINGLE DIAMOND PATTERN)	TRY605781F
17.5 X 25, 14 X 24	(7/16" - 11MM)	SMT (SINGLE DIAMOND PATTERN)	TRY605762F
20.5 X 25	(7/16" - 11MM)	SMT (SINGLE DIAMOND PATTERN)	TRY605764F
20.5 X 25	(1/2" - 13MM)	SMT (SINGLE DIAMOND PATTERN)	TRY606764F
23.5 X 25	(1/2" - 13MM)	SMT (SINGLE DIAMOND PATTERN)	TRY606766F
30.5 X 32, 26.5 X 25, 29.5X25	(3/4" - 19MM)	SMT (SINGLE DIAMOND PATTERN)	TRY611471F
35.5 X 32, 35/65X33	(3/4" - 19MM)	SMT (DOUBLE DIAMOND PATTERN)	TRY611482F

V-BAR TIRE CHAINS

V-BAR CHAINS PROVIDE GREAT TRACTION FOR THE WORST SITUATIONS. BEST USED WHEN INCREASED TRACTION IS NEEDED, RECOMMENDED FOR OFF-ROAD USE. FOR LIGHT TRUCKS AND PASSENGER VEHICLES. ****MUST PREFIT CHAINS BEFORE USE****

TIRE SIZE	SINGLES WITH CAMS	TRIPLES WITH CAMS
315/70R15LT 33X12.50R15 285/75R16LT 307/70R16LT 33X12.50R16.5 P28570R17 285/75R17LT P275/60R18 275/70R18LT 285/65R18LT 33X12.50R18 P265/60R20 P275/55R20 33X12.50R20	VC295 18.5 X 76.8 CROSS CHAIN REPLACEMENT V5340	
P315/70R15 35X12.50R15 295/75R16LT 305/85R16LT P315/70R16 315/75R16LT 35X12.5R16.5 295/70R17LT 315/70R17 325/70R17LT 35X12.50R17 285/75R18LT 35X12.50R18 295/60R22.5	VC296 18.5 X 82.6 CROSS CHAIN REPLACEMENT V5340	
P235/75R15 235/75R15LT 225/75R16LT 8.00R16.5 8.75-16.5	VC312 14.4 X 69.1 CROSS CHAIN REPLACEMENT V5315	
7.00R15LT 7.5015LT P265/70R15 265/75R15LT P275/60R15 31X10.50R15 7.50R16LT 215/85R16LT 225/75R16LT P235/70R16 245/75R16LT P255/65R16 255/65R16LT 255/75R16LT 8.75R16.5 9.50R16.5 30X9.5R16.5 225/75R17LT 235/80R17LT P255/65R17 P265/65R17 7/8R17.5 P215/75R17.5 P255/55R18	VC315 14.4 X 76.8 CROSS CHAIN REPLACEMENT V5315	VC715 14.4 X 81.02 CROSS CHAIN REPLACEMENT V5315
8.25X15LT 32X11.50R15 33X9.50R15 33X10.50R15 P285/75R15 235/85R16LT P255/70R16 265/75R16LT P275/70R16 10R16.5 7.50R17LT P235/80R17 P245/70R17 245/75R17LT P255/70R17 P255/75R17 P265/70R18 P265/60R18 P265/65R18 P275/60R18 8R19.5 225/70R19.5	VC320 14.4 X 82.6 CROSS CHAIN REPLACEMENT V5315	VC720 14.4 X 84.4 CROSS CHAIN REPLACEMENT V5315

V-BAR TIRE CHAINS

TIRE SIZE	SINGLES WITH CAMS	TRIPLES WITH CAMS
245/85R16LT 255/85R16LT 275/70R17 10R17.5 245/70R19.5 7.50R20 8R22.5	VC322 14.4 X 94.1 CROSS CHAIN REPLACEMENT V5315	VC722 14.4 X 90.2 CROSS CHAIN REPLACEMENT V5315
9.00X16 10.5X18 265/70R19.5 8.25R20 9R22.5 235/80R22.5 245/75R22.5 255/70R22.5 255/80R22.5	VC332 16.9 X 94.1 CROSS CHAIN REPLACEMENT V5330	VC732 16.9 X 90.2 CROSS CHAIN REPLACEMENT V5330
37X12.50R16.5 355/70R17LT 37X13.50R17 285/70R19.5 9.00R20 10R22.5 265/75R22.5	VC342 18.5 X 94.1 CROSS CHAIN REPLACEMENT V5340HD	VC742 18.5 X 96 CROSS CHAIN REPLACEMENT V5340HD
10.00R20 38X13.50R20 11R22.5 275/80R22.5 285/75R22.5 295/75R22.5	VC343HD 18.5 X 101.7 CROSS CHAIN REPLACEMENT V5340HD	VC743HD 18.5 X 105.6 CROSS CHAIN REPLACEMENT V5340HD
10.00R22 315/80R22.5 11R24.5 275/80R24.5 285/75R24.5 295/75R24.5	VC344HD 18.5 X 109.4 CROSS CHAIN REPLACEMENT V5340HD	VC744HD 18.5 X 113.3 CROSS CHAIN REPLACEMENT V5340HD
38X15.50R18 11.00R20 39.5X15R20 12R22.5 12.75R22.5	VC355HD 20.2 X 97.9 CROSS CHAIN REPLACEMENT V5355	VC755HD

V-BAR TIRE CHAINS

TIRE SIZE	SINGLES WITH CAMS	TRIPLES WITH CAMS
15X19.5 12.00R20 13/80R20 17.80R20 11.00R22 315/80R22.5 12R24.5	VC356HD 20.2 X 97.9 CROSS CHAIN REPLACEMENT V5355	VC756HD
355/80R20 11.00R24	VC357 20.2 X 115.2 CROSS CHAIN REPLACEMENT V5355	VC757 20.2 x 115.2 CROSS CHAIN REPLACEMENT V5355
365/80R20 12.00R24	VC372 20.2 X 120.7 CROSS CHAIN REPLACEMENT V5355	VC772 20.2 X 120.7 CROSS CHAIN REPLACEMENT V5355
14.00R20 425/65R22.5 445/65R22.5 13.00R24	VC377 23.0 X 122.9 CROSS CHAIN REPLACEMENT V5370	VC777 23.0 X 122.9 CROSS CHAIN REPLACEMENT V5370
13.50R24 14.00R24	VC379 23.0 X 134.4 CROSS CHAIN REPLACEMENT V5370	VC779 23.0 X 134.4 CROSS CHAIN REPLACEMENT V5370





STUDED LIGHT TRUCK CHAINS

TIRE SIZE	SINGLES WITH CAMS	TRIPLES WITH CAMS
7.00R15LT 7.5015LT P265/70R15 265/75R15LT P275/60R15 31X10.50R15 7.50R16LT 215/85R16LT 225/75R16LT P235/70R16 245/75R16LT P255/65R16 255/65R16LT 255/75R16LT 8.75R16.5 9.50R16.5 30X9.5R16.5 225/75R17LT 235/80R17LT P255/65R17 P265/65R17 7/8R17.5 P215/75R17.5 P255/55R18	VC315SF 14.4 X 76.8 CROSS CHAIN REPLACEMENT V5315	VC715SF 14.4 X 81.02 CROSS CHAIN REPLACEMENT V5315
8.25X15LT 32X11.50R15 33X9.50R15 33X10.50R15 P285/75R15 235/85R16LT P255/70R16 265/75R16LT P275/70R16 10R16.5 7.50R17LT P235/80R17 P245/70R17 245/75R17LT P255/70R17 P255/75R17 P265/70R18 P265/60R18 P265/65R18 P275/60R18 8R19.5 225/70R19.5	VC320SF 14.4 X 82.6 CROSS CHAIN REPLACEMENT V5315	VC720SF 14.4 X 84.4 CROSS CHAIN REPLACEMENT V5315
245/85R16LT 255/85R16LT 275/70R17 10R17.5 245/70R19.5 7.50R20 8R22.5	VC322SF 14.4 X 94.1 CROSS CHAIN REPLACEMENT V5315	VC722SF 14.4 X 90.2 CROSS CHAIN REPLACEMENT V5315



TRACTOR TIRE CHAINS

H-PATTERN CROSS CHAINS ASSISTS IN KEEPING CHAINS SITTING ON TOP OF THE TREAD WHERE THEY ARE SUPPOSED TO BE. THESE ARE BUILT WITH 3/8" REGULAR ROUND. RECOMMENDED FOR OFF-ROAD USE. **MUST PREFIT CHAINS BEFORE USE**

V-BAR OPTIONS ARE AVAILABLE PLEASE ADD "V" TO THE PART NUMBER

TIRE SIZE	PART NUMBER	REPLACEMENT CROSS CHAIN
9.5-24 9.5 11.2-24	DU0214	DU0292
9.5-32 11.2-28 230/95R32 355/80R20	DU0226	DU0292
10.5/80-18 12-16.5 280/70R20 300/70R20 315/75D15	DU0225	DU0293
12.4-24	DU0229	DU0293
9.5-36 9.5-38 11.2-32 12.4-28	DU0218	DU0293
13.9-36 320/85R34	DU0242	DU0294
13.6-24 13.6-26 14.9-24	DU0240	DU0295
14.9-26	DU0250	DU0295
19.4-28 14.9-30	DU0252	DU0295
13.6-28 16.9-24 320/85R38 340/85R28 380/85R34	DU0260	DU0296
17.5-24 17.5L-24	DU0263	DU0297
16.9 - 26 16.9-28 420/85R28	DU0262	DU0297
16.9-32	DU0266	DU0297
16.9-34 230/95R44	DU0270	DU0297
18.4-16.1 215.L-16.1	DU0264	DU0298
18.4-24 19.5L-24	DU0268	DU0298
16.9-30 18.4-26 18.4-28 18.4-30 540/65R30 550/65R25 600/65R28	DU0271	DU0298
18.4-34 480/85R34 600/65R25	DU0273	DU0298

TRACTOR TIRE CHAINS

TIRE SIZE	PART NUMBER	REPLACEMENT CROSS CHAIN
16.9-38 18.4-38 20.8-34 380/90R50 420/80R46 460/85R34 480/80R38	DU0272	DU0298
18.4-42 18.4-46 380/950R54 480/80R46	DU0277	DU0298
20.8-38	DU0276	DU0299
24.5-32 23.1-34 28.1-34 620/70R42 650/75R32	DU0282	DU0302

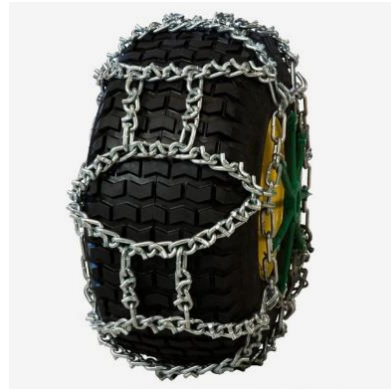

FORKLIFT TIRE CHAINS

THESE 5/16" TWIST LINK CHAINS ARE CARBON STEEL SUITABLE FOR CONCRETE AND ASPHALT. DOUBLE DUTY FOR MAXIMUM COVERAGE AND TRACTION. CABLE CHAINS ARE ALSO AVAILABLE FOR LOW CLEARANCE ISSUES.

TIRE SIZE	DOUBLE DUTY TWIST LINK (2-LINK SPACING)	TIRE SIZE	HEAVY DUTY CABLE
600X9, 18X8X14, 18X9X14, 21X5X15, 21X6X15, 21X6X15, 21X7X15,	T1401-2	5.00X8, 16X6-8, 18X7-8, 600X9, 21X5X15, 21X6X15, 21X7X15, 22X5X16, 22X6X16, 22X7X16	V1400F-10
21X8-9, 6.50X10, 21X8X15, 21X9X15, 22X5X16, 22X6X16, 22X8X16	T1402-2	21X8-9, 6.50X10, 7.50X10, 700X12, 18X8X14, 18X9X14, 21X8X15, 21X9X15, 22X8X16, 22X9X16	V1400F-12
7.50X10, 700X12, 22X9X16, 22X10X16	T1403-2	23X9-10, 23X10-12, 23X10-12, 250X15, 700X15, 750X15, 815X15, 8.25X15, 28X9-15, 28X12.5-15, 7.50X16	V1400F-15
27X10-12, 700X15, 815X15, 28X9X15	T1404-2	300x15, 32x12.1-15, 22x14x16	V1400F-18
8.25X15, 22X12X22	T1408-2		
300X15, 32X12.1-15	T1409-2		



SKIDSTEER TIRE CHAINS

ALLOY STEEL FOR LONGER LASTING TIRE CHAINS. THESE CHAINS CAN BE RUN BOTH SIDES FOR MAXIMUM LIFE. DOUBLE DUTY OFFERS MORE COVERAGE

TIRE SIZE	SINGLE DUTY SQUARE LINK 4 LINK SPACING	DOUBLE DUTY SQUARE LINK 2 LINK SPACING	SQUARE LINK BAR STUD H-PATTERN
10X16.5	T10X165SD516SQ	T10X165DD516SQ	T10X165HPAT
33X12.5X15, 31X15.5-15, 31X13X16.5, 12X16.5	T12X165SD516SQ	T12X165DD516SQ	T12X165HPAT
36X13.5-15, 33X15.5-16, 14X17.5, 12.580-18	T14X175SD516SQ	T14X175DD516SQ	T14X165HPAT



SNOW BLOWER & GARDEN TRACTOR CHAINS

MADE FROM CARBON STEEL AVAILABLE IN SINGLE DUTY AND DOUBLE DUTY TWIST LINK.

TIRE SIZE	SINGLE DUTY SQUARE LINK 4 LINK SPACING	DOUBLE DUTY SQUARE LINK 2 LINK SPACING
10/10.5x2.75 10.25x3.25 10x3.50		7803301
12x3		7803308
4.10/3.50X4 3.40/3.00X5		7807106
4.10/3.50X5 4.10/3.50X6 12X3.50X6 12.25X3.50X6		7803302
5.30/4.50X6		7803309
13X5X6		7807129
4.00/4.80X8		7801301
5.00/5.70X8		7803303
16X6.50X8		7803300
18X6.50X8		7803312
18X9.50X8	7803306G	7803305
20X10X8 20X10X10	7805320G	7807145
20X8.00X10 20X8X8	7805318G	7801308
6X12 23X7.50X12	7805312G	7805313
8X12 23X8.50X12	7804301G	7804300
12X12 26X12X12 27X12X12	7805306G	7805308
29X9.50X12 23X10.50	7805303G	7805307
24X12X12		7807164
8X15 25X8.5X14 X27X8.50X15	7801309G	7801307
29X12X15	7805316G	7805323
12.4-16 31X15.5X15 33X12.5X15	7805324G	7809100
8X16	7801310G	7801311

TIRE CHAIN PARTS

ITEM DESCRIPTION	PART NUMBER (TRYGG)	PART NUMBER (OPTION)
#2 C-HOOK (6-7 MM)		T10246102
#3 C-HOOK (8-10MM)	TRY333230	T10246103DY
3/8" HEAVY DUTY DIVERSIFIED C-HOOK		TCHOOK
6-7 BOOMER C/W LINK	TRY331030	T10246320WF
8-9 BOOMER C/W LINK	TRY331040	T10246330WF
10-11 BOOMER C/W LINK	TRY331050	T10246110QC
CAM WRENCH	TRY344300	TTWRENCH
LONG HANDLE TIRE CHAIN PLIERS		711PLIER
TIRE CHAIN ADJUSTER 25"-32" (4 POINT)		T0296
SKIDDER CHAIN MOUNTING TOOL		TSKID/FINGERQC
SKIDDER CHAIN TIGHTENING		TSKIDTIGHT/SCREW
HEAVY DUTY SCREW ACTUATED TIGHTENER	TSKIDTIGHT/JACK	
SPIDER TENSIONER ATV/GARDEN TRACTOR (UP TO 14") GREEN		VQ0213
SPIDER TENSIONER PASSENGER (12"-15") YELLOW		VQ0212
SPIDER TENSIONER LIGHT TRUCK (16"-20") BLUE		VQ0216
SPIDER TENSIONER TRUCK (22.5" - 24.5") RED		VQ0218
SPIDER TENSIONER SMALL LOADER/TRACTOR (25"-38") BLACK		VQ0220
1/4" QUICK LINK		D66432
5/16" QUICK LINK		D66433
3/8" QUICK LINK		D66434
1/8" x 3/4" LAP LINK		D66400
3/16" x 1" LAP LINK		D66401
1/4" x 1-1/2" LAP LINK		D66402
5/16" x 1-1/2" LAP LINK		D66403
3/8" x 1-5/8" LAP LINK		D66404
7/32" (6-7MM) T - PIN COUPLER		T10249505
5/16" (8MM) T- PIN COUPLER		T10249508
3/8"-7/16" (10-11MM) T - PIN COUPLER		T10249595
1/2" (13MM) T - PIN COUPLER		T10249313
5/8" (16MM) T- PIN COUPLER		T10249316

TIRE CHAIN PARTS

ITEM DESCRIPTION	PART NUMBER (TRYGG)	PART NUMBER (OPTION)
3-4"-7/8" (19-22MM) T- PIN COUPLER		T10249322
7MM CROSS CHAIN HOOK	TRY320070	V0064
8MM CROSS CHAIN HOOK	TRY320080	V0078S
8MM (S2000) CROSS CHAIN HOOK	TRY323080	
10MM CROSS CHAIN HOOK	TRY320100	T10253100QC
11MM CROSS CHAIN HOOK	TRY320110	T10253110QC (V0437)
13MM CROSS CHAIN HOOK	TRY320130	
CHAIN CLAW 3 IN 1 TOOL	TRY350004	
7MM (9/32") STUDDED CROSS CHAIN S2000	TRY301071	
8MM (5/16") STUDDED CROSS CHAIN	TRY301080	
9.5MM STUDDED CROSS CHAIN	TRY301095	
11MM STUDDED CROSS CHAIN	TRY301110	
5.5MM (7/32") SQUARE LINK CROSS CHAIN		T1420600
7MM (9/32") SQUARE LINK CROSS CHAIN		T1420700
8MM (5/16") SQUARE LINK CROSS CHAIN		T1420800
9/32" (6/0) RR CROSS CHAIN		VXC932RR
5/16"(7/0) RR CROSS CHAIN		VXC516RR
3/8" (9/0) RR CROSS CHAIN		VXC38RR
7/16"(11/0) RR CROSS CHAIN		VXC716RR
7MM CROSS CHAIN HOOK	TRY320070	V0064
8MM CROSS CHAIN HOOK	TRY320080	V0078S
8MM (S2000) CROSS CHAIN HOOK	TRY323080	
10MM CROSS CHAIN HOOK	TRY320100	T10253100QC
11MM CROSS CHAIN HOOK	TRY320110	T10253110QC (V0437)
13MM CROSS CHAIN HOOK	TRY320130	
CHAIN CLAW 3 IN 1 TOOL	TRY350004	
7MM (9/32") STUDDED CROSS CHAIN S2000	TRY301071	
8MM (5/16") STUDDED CROSS CHAIN	TRY301080	
9.5MM STUDDED CROSS CHAIN	TRY301095	
11MM STUDDED CROSS CHAIN	TRY301110	
5.5MM (7/32") SQUARE LINK CROSS CHAIN		T1420600
7MM (9/32") SQUARE LINK CROSS CHAIN		T1420700
8MM (5/16") SQUARE LINK CROSS CHAIN		T1420800

TIRE CHAIN PARTS

ITEM DESCRIPTION	PART NUMBER (TRYGG)	PART NUMBER (OPTION)
9/32" (6/0) RR CROSS CHAIN		VXC932RR
5/16"(7/0) RR CROSS CHAIN		VXC516RR
3/8" (9/0) RR CROSS CHAIN		VXC38RR
7/16"(11/0) RR CROSS CHAIN		VXC716RR
11MM SIDE CH	TRY311110	
13MM SIDE CH	TRY311131	
TIRE CHAIN CLAW	TRY350004	

TIRE CHAIN PARTS



**INSIDE RAIL
C-HOOK**



**OUTSIDE RAIL
BOOMER
W/LINK**



T-WRENCH



QUICK LINK



**SPIDER
BUNGEE**



LAP LINK

TIRE CHAIN PARTS



T-COUPLER



CROSS CHAIN HOOK



SQUARE LINK CROSS CHAIN



TWIST LINK CROSS CHAIN



DIVERSIFIED C-HOOK



STUDED CROSS CHAIN



**TSKIDTIGHT/
JACK**



TIRE CHAIN CLAW

TIRE CHAIN PARTS HELP

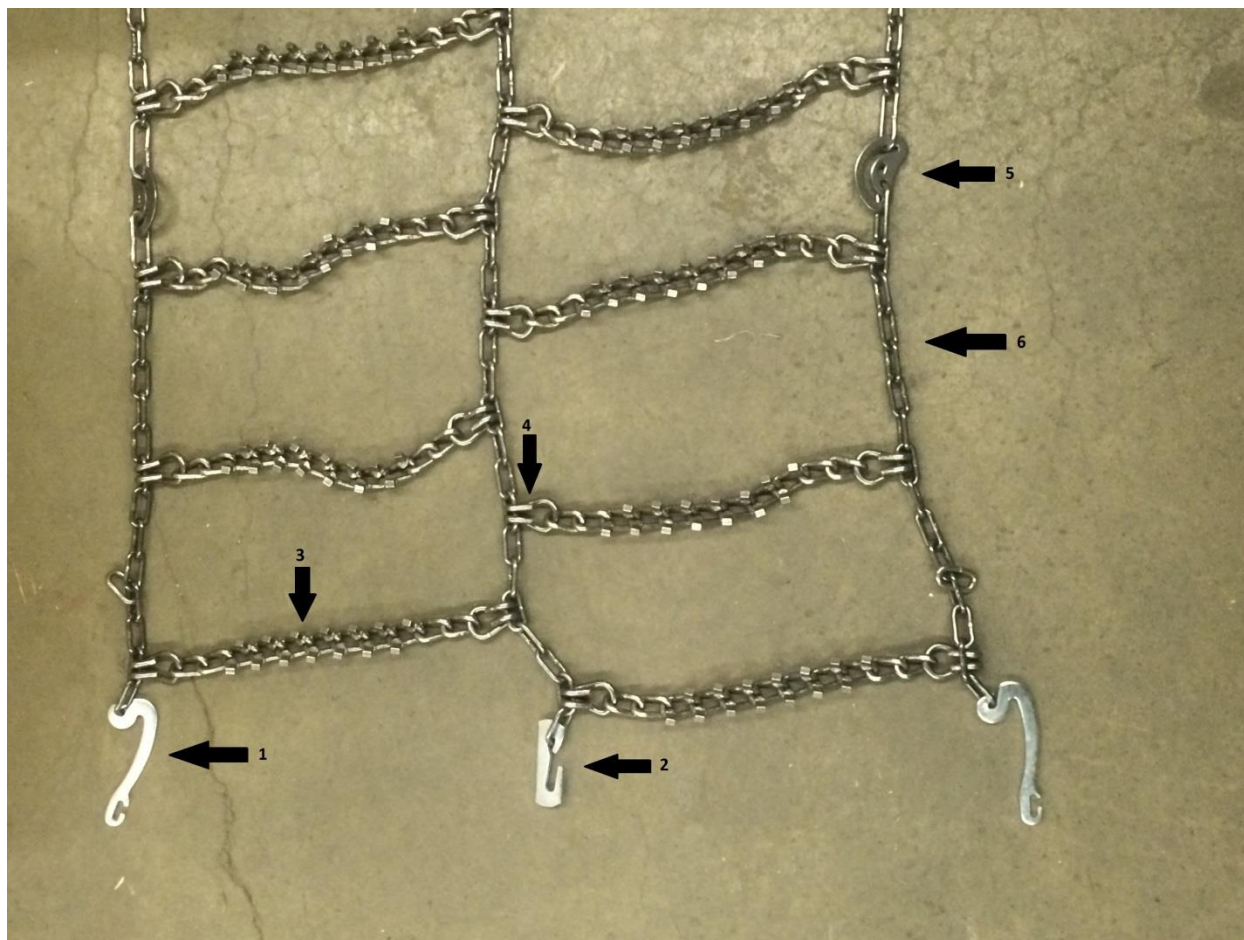

- 1.) BOOMER - OUTSIDE RAIL END HOOKS 2.) C-HOOK - INSIDE RAIL END HOOK
3.) CROSS CHAIN - ACROSS THE TREAD 4.) CROSS CHAIN HOOK
5.) CAM LOCK - ASSIST IN TIGHTENING 6.) SIDE CHAIN - SIDE WALL OF TIRE

EASIEST WAY TO INSTALL TIRE CHAINS

1.) LAY CHAINS OUT FLAT AND REMOVE ALL TANGLES. WHEN CHAINS ARE PLACED ON TIRE, CROSS CHAIN HOOKS MUST FACE UP. DAMAGE TO YOUR TIRES COULD RESULT IF HOOKS FACE IN AGAINST TIRE.

2.) LAY CHAIN OVER THE TIRE, CROSS CHAIN HOOKS EYES UP AND RED FASTENER ON THE OUTSIDE OF THE TIRE. TUCK THE FIRST CROSS CHAIN (SIDE WITHOUT THE FASTENERS) UNDER THE TIRE.

3.) MOVE THE VEHICLE UNTIL THE OUTSIDE FASTENER IS AXLE HIGH.

4.) FASTEN INSIDE "C-HOOK" TO PROPER LINK OF INNER SIDE CHAIN THAT WILL ALLOW THE CROSS CHAIN TO BE STRAIGHT ACROSS THE TIRE TREAD AFTER FINAL HOOK-UP.

5.) REMOVE SLACK AND HOOK OUTSIDE "BOOMER" SLIP SIDE CHAIN OVER AND AROUND THE BEND AT THE END OF THE HOOK. (TANG END)

6.) GRASP FASTENER AND FOLD BACK 180 DEGRESS. ENGAGE TANG END OF THE BOOMER IN HANGING LINK. MAKE THE CHAIN AS TIGHT AS POSSIBLE BY HAND WITHOUT THE USE OF TOOLS.

7.) DRIVE ABOUT ¼ MILE, STOP AND RETIGHTEN. EXTRA LINKS MAY BE CUT OFF OR RETAINED ON THE BOOMER ARM (AS SHOWN). KEEP CHAINS TIGHT TO SNUIG THROUGHOUT OPERATION. ONLY AFTER RETIGHTENING SHOULD SPIDER TENSIONERS BE APPLIED.

1.)

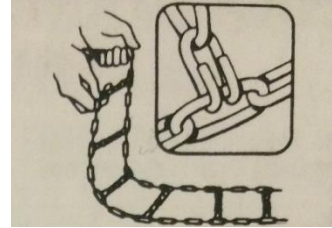

2.)

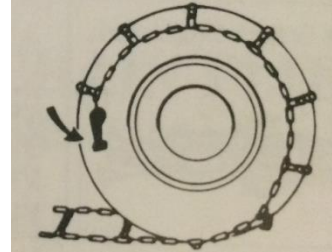

3.)

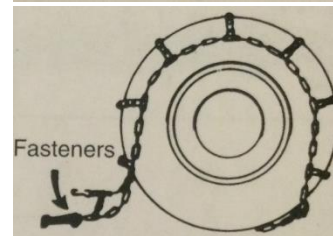

4.)

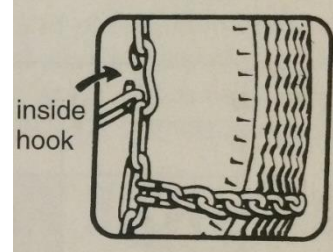

5.)

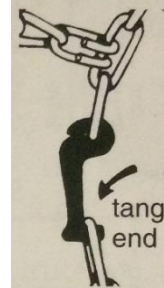

6.)



7.)



SYNTHETIC SLINGS



SYNTHETIC SLINGS



**2 PLY ENDLESS
POLYESTER WEB SLING**



**2 PLY EYE AND EYE WEB
SLING WITH BODY WEAR
PAD**



**POLYESTER ROUND
SLING**



**2 PLY EYE AND EYE
POLYESTER SLING**

SYNTHETIC WEB SLING CHARACTERISTICS

CHEMICAL ENVIROMENT	NYLON	POLYESTER
ACIDS	<i>NO</i>	<i>CAUTION</i>
ALCOHOLS	<i>YES</i>	<i>YES</i>
ALDEHYDE	<i>YES</i>	<i>NO</i>
ALKALIS	<i>YES</i>	<i>CAUTION</i>
BLEACH	<i>NO</i>	<i>YES</i>
CLEANING AGENTS	<i>CAUTION</i>	<i>CAUTION</i>
HYDRO CARBONS	<i>YES</i>	<i>YES</i>
ETHERS	<i>YES</i>	<i>NO</i>
KETONES	<i>YES</i>	<i>YES</i>
OILS/CRUDE	<i>YES</i>	<i>YES</i>
SOAPS	<i>YES</i>	<i>YES</i>
STRENGTH LOSS WHEN WET	15%	0%
MAXIMUM TEMPERATURE USE	194 F/90 C -40C/-40F	194 F/90 C -40C/-40F
STRENGTH LOSS AFTER 1 YEAR OF UV EXPOSURE	40-60%	30%

***CAUTION MEANS SUBJECT TO STRENGTH LOSS AND/OR SOME DEGRADATION*
RESULTS AS PER WSTDA**

(ALL SLINGS ARE TO BE USED AND INSPECTED AS REQUIRED BY ASME B30.9)

DEPENDING ON THE WIDTH AND PLY OF SLINGS THESE ARE ABLE TO PROVIDE DIFFERENT LIFTING CAPACITIES. THE MOST COMMON OF THESE SLINGS ARE THE EYE AND EYE. SYNTHETIC WEB SLINGS COME IN A VARIETY OF DIFFERENT TYPES IN ORDER TO BETTER SERVE A PARTICULAR PURPOSE. MULTIPLE SLING CONFIGURATIONS ALLOW A USER TO FIND A SLING THAT IS MOST ADAPTABLE TO THE APPLICATION FOR WHICH A SLING IS USED. THE LENGTH OF THE SLING HAS NO BEARING ON LOAD CAPACTIY. SEE CAPACITY CHART STARTING ON PAGE 31.

DIFFERENT STYLES OF WEB SLINGS

TC – TRIANGLE/CHOKER (TYPE 1)



TYPE 1 IS A VERSATILE SLING TYPE THAT HAS STEEL END FITTINGS TO ALLOW THE SLINGS TO BE EASILY USED IN A BASKET OR CHOKER CONFIGURATION. THIS STYLE CAN SLIP ONE TRIANGLE THROUGH THE OTHER SO IT CAN BE USED IN A CHOKER LIFT. THESE FITTINGS ALSO REDUCE WEAR AND ALLOW EASIER CONNECTION TO MOST HOIST HOOKS.

TT – TRIANGLE/TRIANGLE (TYPE 2)



TYPE 2 SLINGS ARE THE SAME AS TYPE 1 EXCEPT EACH END HAS AN IDENTICAL TRIANGLE ON BOTH ENDS. THIS SLING IS ONLY USED IN A VERTICAL OR BASKET CONFIGURATION.

EE – EYE/EYE FLAT WEB SLINGS

T3 (FLAT EYE'S)



T4 (TWISTED EYE'S)



TYPE 3 & 4 ALSO KNOW AS EYE & EYE SLINGS ARE VERY POPULAR SLINGS WHICH ARE STOCKED IN MULTIPLE CAPACITIES. EYE & EYE SLINGS ARE VERY ADAPTABLE AND ARE A GOOD CHOICE IN MANY LIFTING SITUATIONS. THE FLAT EYE T3 IS USUALLY EASIER TO REMOVE OR INSERT INTO LIMITED SPACES. TYPE 4 SLING IS TWISTED TO STAND OPEN

EN – ENDLESS (TYPE 5)



TYPE 5 ENDLESS SLINGS ARE VERSATILE AND USED FOR GENERAL PURPOSES. THESE SLINGS CAN BE RIGGED IN AN UNLIMITED AMOUNT OF WAYS AND THEY CAN BE READILY ADJUSTED TO COMPENSATE FOR WEAR. ENDLESS SLINGS ARE POPULAR AND EASY TO USE.

SYNTHETIC WEB SLINGS

T3 (FLAT EYE'S) OR T4 (TWISTED EYE'S)

LOAD RATING FOR EE1 - T3/T4 (EYE/EYE ONE PLY)

WIDTH	VERTICAL	CHOKER	BASKET	TWO-LEGGED 60° DEGREE	MIN SHACKLE SIZE
1"	1,600 LBS	1,280 LBS	3,200 LBS	2,800 LBS	5/8"
2"	3,100 LBS	2,480 LBS	6,200 LBS	5,400 LBS	5/8"
3"	4,700 LBS	3,760 LBS	9,400 LBS	8,100 LBS	7/8"
4"	6,200 LBS	4,960 LBS	12,400 LBS	10,700 LBS	1"
5"	7,800 LBS	6,240 LBS	15,600 LBS	13,500 LBS	1-1/8"
6"	9,300 LBS	7,440 LBS	18,600 LBS	16,100 LBS	1-1/4"
8"	11,750 LBS	9,400 LBS	23,500 LBS	18,300 LBS	1-1/4"
10"	14,700 LBS	11,760 LBS	29,400 LBS	22,900 LBS	1-3/8"
12"	17,650 LBS	14,120 LBS	35,300 LBS	27,500 LBS	1-1/2"

LOAD RATING FOR EE2 - T3/T4 (EYE/EYE TWO PLY)

WIDTH	VERTICAL	CHOKER	BASKET	TWO-LEGGED 60° DEGREE	MIN SHACKLE SIZE
1"	3,100 LBS	2,480 LBS	6,200 LBS	5,400 LBS	5/8"
2"	6,200 LBS	4,960 LBS	12,400 LBS	10,700 LBS	5/8"
3"	8,800 LBS	7,040 LBS	17,600 LBS	15,200 LBS	7/8"
4"	11,000 LBS	8,800 LBS	22,000 LBS	19,100 LBS	1"
5"	13,700 LBS	10,960 LBS	27,400 LBS	23,700 LBS	1-1/8"
6"	16,500 LBS	13,200 LBS	33,000 LBS	28,600 LBS	1-1/4"
8"	22,750 LBS	18,200 LBS	45,500 LBS	36,700 LBS	1-1/4"
10"	28,400 LBS	22,720 LBS	56,800 LBS	45,800 LBS	1-3/8"
12"	34,100 LBS	27,280 LBS	68,200 LBS	55,000 LBS	1-1/2"

T5 – ENDLESS WEB SLINGS

LOAD RATING FOR EN1 – T5 (ENDLESS ONE PLY)

WIDTH	VERTICAL	MIN SHACKLE SIZE	MAX SHACKLE SIZE
1"	3,200 LBS	5/8"	3"
2"	6,200 LBS	5/8"	3"
3"	9,400 LBS	7/8"	4"
4"	12,400 LBS	1"	4"
5"	15,600 LBS	1-1/8"	4-1/2"
6"	18,600 LBS	1-1/4"	5-3/10"
8"	21,150 LBS	1-1/4"	7-3/10"
10"	26,450 LBS	1-3/8"	8-3/10"
12"	31,750 LBS	1-1/2"	10"

LOAD RATING FOR EN2 – T5 (ENDLESS TWO PLY)

WIDTH	VERTICAL	MIN SHACKLE SIZE	MAX SHACKLE SIZE
1"	6,200 LBS	5/8"	3"
2"	12,400 LBS	5/8"	3"
3"	17,600 LBS	7/8"	4"
4"	22,000 LBS	1"	4"
5"	27,400 LBS	1-1/8"	4-1/2"
6"	33,000 LBS	1-1/4"	5-3/10"
8"	42,350 LBS	1-1/4"	7-3/10"
10"	52,900 LBS	1-3/8"	8-3/10"
12"	63,500 LBS	1-1/2"	10"

MANUFACTURER'S SPECIFICATIONS

- 1.) OUR POLYESTER SLINGS HAVE A 5:1 DESIGN FACTOR
- 2.) EACH SLING IS INDIVIDUALLY SERIALIZED FOR COMPLETE TRACEABILITY
- 3.) POLYESTER AND NYLON SLINGS SHALL NOT BE USED IN TEMPERATURES IN EXCESS OF 90C OR BELOW -40C
- 4.) A SYNTHETIC SLING NEEDS TO BE TAKEN OUT OF SERVICE IF THE TAG IS ILLEGIBLE OR MISSING. MELTING OR CHARRING OF ANY PART OF THE SLING. HOLES, TEARS, CUTS, CUTS OR SNAGS. BROKEN OR WORN STITCHING. EXCESSIVE WEAR. KNOTS ON ANY PART OF THE SLING. DISCOLORATION, BRITTLE OR STIFF AREAS ON ANY PART OF THE SLING. FITTINGS THAT ARE DAMAGED. ANY OTHER VISIBLE DAMAGE THAT MAY CAUSE DOUBT IN CONTINUING THE USE OF THE SLING.
- 5.) OUR SLINGS MEET OR EXCEED EXPECTATIONS FROM OHSA, ASME B30.9 AND WSTDA
- 6.) SLINGS NEED TO BE INSPECTED BY TRAINED EMPLOYEE BEFORE EVERY USE
- 7.) NEVER GO OVER RATED CAPACITY

SYNTHETIC ROUND SLINGS



POLYESTER AND CORDURA ROUND SLINGS

SIZE	COLOR	VERTICAL	CHOKER	BASKET	APX WEIGHT/ FOOT LBS
PR3	PURPLE	2,600 LBS	2,100 LBS	5,200 LBS	0.17
PR6	GREEN	5,300 LBS	4,200 LBS	10,600 LBS	0.30
PR9	YELLOW	8,400 LBS	6,700 LBS	16,800 LBS	0.43
PR11	TAN	10,600 LBS	8,500 LBS	21,200 LBS	0.74
PR14	RED	13,200 LBS	10,600 LBS	26,400 LBS	0.80
PR17	BROWN	16,800 LBS	13,400 LBS	33,600 LBS	0.86
PR22	BLUE	21,200 LBS	17,000 LBS	42,400 LBS	1.03
PR25	LIGHT BLUE	25,000 LBS	20,000 LBS	50,000 LBS	1.12
PR31	GREY	31,000 LBS	24,800 LBS	62,000 LBS	1.60
PR40	ORANGE	40,000 LBS	32,000 LBS	80,000 LBS	1.92
PR53	ORANGE	53,000 LBS	42,400 LBS	106,000 LBS	2.67
PR66	ORANGE	66,000 LBS	52,800 LBS	132,000 LBS	3.10
PR90	BLACK	90,000 LBS	72,00 LBS	180,000 LBS	4.10

****CORDURA ROUND SLINGS ARE SAME SIZE AND CAPCITY USE “CR” INSTEAD OF “PR”****

Polyester endless round slings are popular for their versatility and strength. They can be used in choker, vertical and basket hitch. Polyester endless round slings are in an endless loop. The endless loop allows the load contact point to change with each application. The alternating of load points helps extend the life of the round endless sling.

Our polyester round slings are built using a double polyester jacket with the yarns enclosed.

This jacket protects the inner lifting fibers from wear, abrasion and exposure to other environmental conditions. All polyester endless round slings are load rated and come with a raised rubber tag for easy identification.

Our Polyester Round Slings are manufactured in accordance with ASME B30.9 standards.

We offer polyester round slings in various sizes and rating capacities.

EZ LIFT HIGH PERFORMANCE ROUND SLINGS

SIZE	VERTICAL	CHOKER	BASKET	WEIGHT PER FOOT(APX)
EZ25	25,000 LBS	20,000 LBS	50,000 LBS	0.50/FT
EZ35	35,000 LBS	28,000 LBS	70,000 LBS	0.75/FT
EZ45	45,000 LBS	36,000 LBS	90,000 LBS	0.80/FT
EZ55	55,000 LBS	44,000 LBS	110,000 LBS	1.00/FT
EZ65	65,000 LBS	52,000 LBS	130,000 LBS	1.10/FT
EZ90	90,000 LBS	72,000 LBS	180,000 LBS	1.40/FT
EZ100	100,000 LBS	80,000 LBS	200,000 LBS	1.50/FT
EZ125	125,000 LBS	100,000 LBS	250,000 LBS	1.50/FT
EZ150	150,000 LBS	120,000 LBS	300,000 LBS	2.30/FT
EZ200	200,000 LBS	160,000 LBS	400,000 LBS	2.70/FT
EZ250	250,000 LBS	200,000 LBS	500,000 LBS	3.70/FT
EZ350	350,000 LBS	280,000 LBS	700,000 LBS	5.50/FT

WIRE ROPE SLINGS & BRIDLES



WIRE ROPE SLINGS AND BRIDLES



**SLING HOOK
WITH LATCH**



**SWIVEL
HOOK WITH
LATCH**



**SAFETY
SWIVEL
WITH LATCH**



**SAFETY
HOOK WITH
LATCH**



**SLIDING
CHOKER
HOOK**



**SORTING
HOOK WITH
HANDLE**

WIRE ROPE SINGLE LEG

IWRC – EIPS



SIZE	VERTICAL 90°	CHOKER	BASKET	APPROX. WEIGHT
1/4"	1,300 LBS	960 LBS	2,600 LBS	0.13/FT
5/16"	2,000 LBS	1,480 LBS	4,000 LBS	0.18/FT
3/8"	2,800 LBS	2,200 LBS	5,800 LBS	0.26/FT
7/16"	3,800 LBS	2,800 LBS	7,800 LBS	0.35/FT
1/2"	5,000 LBS	3,800 LBS	10,200 LBS	0.46/FT
9/16"	6,400 LBS	4,800 LBS	12,800 LBS	0.58/FT
5/8"	7,800 LBS	5,800 LBS	15,600 LBS	0.72/FT
3/4"	11,200 LBS	8,200 LBS	22,000 LBS	1.04/FT
7/8"	15,200 LBS	11,200 LBS	30,000 LBS	1.42/FT
1"	19,600 LBS	14,400 LBS	40,000 LBS	1.85/FT
1-1/8"	24,000 LBS	18,200 LBS	48,000 LBS	2.34/FT
1-1/4"	30,000 LBS	22,000 LBS	60,000 LBS	2.89/FT
1-3/8"	36,000 LBS	26,000 LBS	72,000 LBS	3.50/FT
1-1/2"	42,000 LBS	32,000 LBS	84,000 LBS	4.16/FT
1-3/4"	56,000 LBS	42,000 LBS	114,000 LBS	5.67/FT
2"	74,000 LBS	56,000 LBS	148,000 LBS	7.39/FT
2-1/4"	88,000 LBS	70,000 LBS	176,000 LBS	9.36/FT
2-1/2"	108,000 LBS	84,000 LBS	216,000 LBS	11.6/FT
2-3/4"	130,000 LBS	102,000 LBS	260,000 LBS	14.0/FT
3"	154,000 LBS	120,000 LBS	306,000 LBS	16.6/FT

TWO LEGGED WIRE ROPE BRIDLES

IWRC – EIPS



Size	W.L.L. 60°	W.L.L. 45°	W.L.L. 30°
1/4"	2,000 LBS	1,820 LBS	1,300 LBS
5/16"	3,400 LBS	2,800 LBS	2,000 LBS
3/8"	5,000 LBS	4,000 LBS	2,800 LBS
7/16"	6,800 LBS	5,400 LBS	3,800 LBS
1/2"	8,800 LBS	7,200 LBS	5,000 LBS
9/16"	11,000 LBS	9,000 LBS	6,400 LBS
5/8"	13,600 LBS	11,000 LBS	7,800 LBS
3/4"	19,400 LBS	15,800 LBS	11,200 LBS
7/8"	26,000 LBS	22,000 LBS	15,200 LBS
1"	34,000 LBS	28,000 LBS	19,600 LBS
1-1/8"	42,000 LBS	34,000 LBS	24,000 LBS
1-1/4"	52,000 LBS	42,000 LBS	30,000 LBS
1-3/8"	62,000 LBS	50,000 LBS	36,000 LBS
1-1/2"	74,000 LBS	60,000 LBS	42,000 LBS

THREE LEGGED WIRE ROPE BRIDLE

IWRC - EIPS



Size	W.L.L 60°	W.L.L. 45°	W.L.L. 30°
1/4"	3,400 LBS	2,800 LBS	1,940 LBS
5/16"	5,200 LBS	4,200 LBS	3,000 LBS
3/8"	7,400 LBS	6,000 LBS	4,400 LBS
7/16"	10,000 LBS	8,200 LBS	5,800 LBS
1/2"	13,200 LBS	10,800 LBS	7,600 LBS
9/16"	16,600 LBS	13,600 LBS	9,600 LBS
5/8"	20,000 LBS	16,600 LBS	11,800 LBS
3/4"	30,000 LBS	24,000 LBS	16,800 LBS
7/8"	40,000 LBS	32,000 LBS	22,000 LBS
1"	52,000 LBS	42,000 LBS	30,000 LBS
1-1/8"	62,000 LBS	52,000 LBS	36,000 LBS
1-1/4"	76,000 LBS	62,000 LBS	44,000 LBS
1-3/8"	92,000 LBS	76,000 LBS	54,000 LBS
1-1/2"	110,000 LBS	90,000 LBS	64,000 LBS

FOUR LEGGED WIRE ROPE BRIDLE

IWRC – EIPS



Size	W.L.L 60°	W.L.L. 45°	W.L.L. 30°
1/4"	4,400 LBS	3,600 LBS	2,600 LBS
5/16"	7,000 LBS	5,600 LBS	4,000 LBS
3/8"	10,000 LBS	8,200 LBS	5,800 LBS
7/16"	13,400 LBS	11,000 LBS	7,800 LBS
1/2"	17,600 LBS	14,200 LBS	10,200 LBS
9/16"	22,000 LBS	18,000 LBS	12,800 LBS
5/8"	28,000 LBS	22,000 LBS	15,600 LBS
3/4"	38,000 LBS	32,000 LBS	22,000 LBS
7/8"	52,000 LBS	42,000 LBS	30,000 LBS
1"	68,000 LBS	56,000 LBS	40,000 LBS
1-1/8"	84,000 LBS	68,000 LBS	48,000 LBS
1-1/4"	102,000 LBS	84,000 LBS	60,000 LBS
1-3/8"	124,000 LBS	100,000 LBS	72,000 LBS
1-1/2"	146,000 LBS	120,000 LBS	84,000 LBS

CONSTRUCTION OF WIRE ROPE

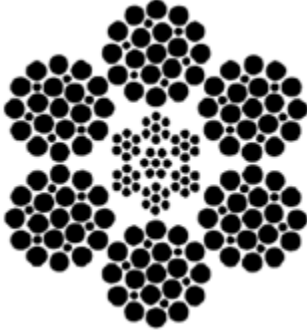

CLASSIFICATION 6X26 WIRE IS ONE OF THE MOST COMMONLY USED. WITH THE FLEXIBILITY AND WEAR RESISTANCE IT CAN BE USED FOR MANY DIFFERENT KINDS OF APPLICATIONS. WITH THE OUTER STRANDS BEING LARGER YOU GET BETTER WEAR COMPARED TO A 6X36 CONSTRUCTION. USED FOR SLINGS AND SMALLER WINCHLINES

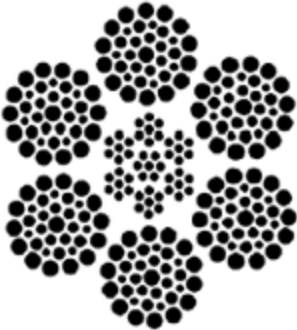

CLASSIFICATION 6X36 IS ALSO COMMONLY USED BECAUSE OF THE SMALLER OUTER STRANDS THIS CABLE OFFERS MAXIMUM FLEXIBILITY. HOWEVER NOT AS WEAR RESISTANT AS 6X26. USED FOR SLINGS AND WINCHLINES

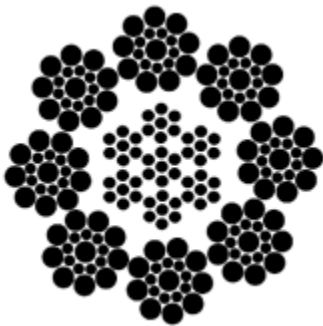

CLASSIFICATION 8X19 IS A SEMI-NON ROTATING CABLE. THIS CABLE IS RECOMMENDED FOR LIFTING UNGUIDED LOADS WITH SINGLE OR MULTI-PART LINES. OUTER STRANDS MANUFACTURED IN A RIGHT LAY WHEREAS THE INNER STRANDS ARE LEFT LAY.

CHAIN SLINGS



TYPE OF CHAIN SLINGS

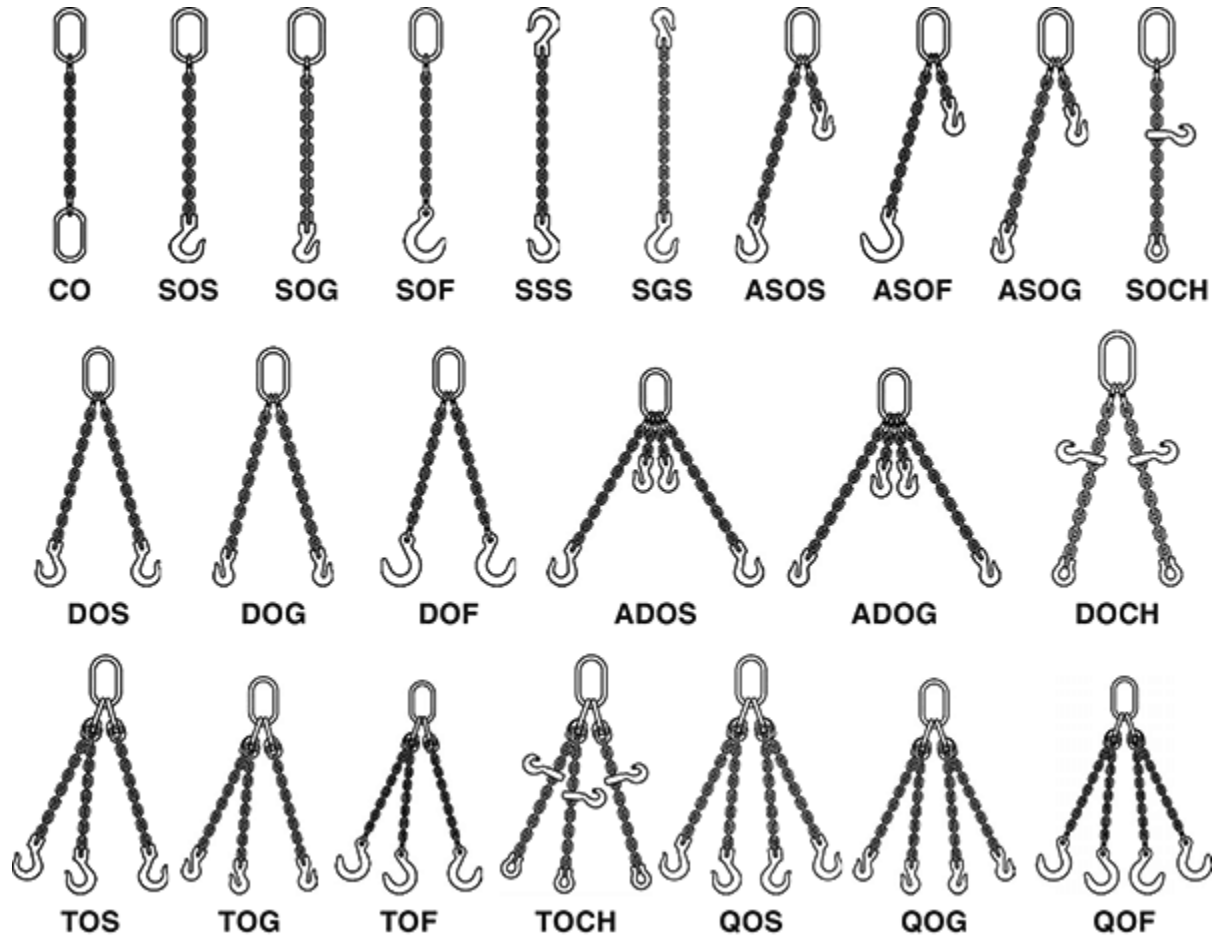

RATINGS FOR GRADE 80 CHAIN SLINGS

CHAIN SIZE	VERTICAL 90°	TWO LEGGED		THREE AND FOUR LEGGED	
		60°	45°	60°	45°
7/32"	2,500 LBS	3,600 LBS	3,000 LBS	5,500 LBS	4,400 LBS
9/32"	3,500 LBS	6,100 LBS	4,900 LBS	9,100 LBS	7,400 LBS
5/16"	4,500 LBS	7,800 LBS	6,400 LBS	11,700 LBS	9,500 LBS
3/8"	7,100 LBS	12,300 LBS	10,000 LBS	18,400 LBS	15,100 LBS
1/2"	12,000 LBS	20,800 LBS	17,000 LBS	31,200 LBS	25,500 LBS
5/8"	18,100 LBS	31,300 LBS	25,600 LBS	47,000 LBS	38,400 LBS
3/4"	28,300 LBS	49,000 LBS	40,000 LBS	73,500 LBS	60,000 LBS
7/8"	34,200 LBS	59,200 LBS	48,400 LBS	88,900 LBS	72,500 LBS
1"	47,700 LBS	82,600 LBS	67,400 LBS	123,900 LBS	101,200 LBS
1-1/4"	72,300 LBS	125,200 LBS	102,200 LBS	187,800 LBS	153,400 LBS
1-1/2"	100,000 LBS	173,200 LBS	141,400 LBS	259,800 LBS	212,100 LBS
1-3/4"	131,250 LBS	227,300 LBS	185,600 LBS	341,000 LBS	278,400 LBS
2"	175,000LBS	303,100 LBS	247,500 LBS	454,600 LBS	371,200 LBS

RATINGS FOR GRADE 100 CHAIN SLINGS

CHAIN SIZE	VERTICAL 90°	TWO LEGGED		THREE AND FOUR LEGGED	
		60°	45°	60°	45°
9/32"	4,300 LBS	7,400 LBS	6,100 LBS	11,200 LBS	9,100 LBS
5/16"	5,700 LBS	9,900 LBS	8,100 LBS	14,800 LBS	12,100 LBS
3/8"	8,800 LBS	15,200 LBS	12,400 LBS	22,900 LBS	18,700 LBS
1/2"	15,000 LBS	26,000 LBS	21,200 LBS	39,000 LBS	31,800 LBS
5/8"	22,600 LBS	39,100 LBS	32,000 LBS	58,700 LBS	47,900 LBS
3/4"	35,300 LBS	61,100 LBS	49,900 LBS	91,700 LBS	74,900 LBS
7/8"	42,700 LBS	74,000 LBS	60,400 LBS	110,900 LBS	90,600 LBS
1"	59,600 LBS	103,200 LBS	84,200 LBS	154,800 LBS	126,400 LBS

CARGO CONTROL



TIE-DOWN STRAPS

1" RATCHET STRAPS



Part Number	Strap Width	Length	Working Load Limit	End Hook
110RWD	1"	10'	830 LBS	Wire Hook W/D-Ring
112RWD	1"	12'	830 LBS	Wire Hook W/D-Ring
116RWD	1"	16'	835 LBS	Wire Hook W/D-Ring
120RWD	1"	20'	835 LBS	Wire Hook W/D-Ring

****CUSTOM LENGTH AVAILABLE UPON REQUEST****

TIE-DOWN STRAP

2" RATCHET STRAP WIRE HOOK



Part Number	Strap Width	Length	Working Load Limit	End Hook
210RWHKIT	2"	10'	3,335 LBS	Wire Hook
215RWHKIT	2"	15'	3,335 LBS	Wire Hook
220RWHKIN	2"	20'	3,335 LBS	Wire Hook
225RWHKIT	2"	25'	3,335 LBS	Wire Hook
230RWHKIN	2"	30'	3,335 LBS	Wire Hook

****CUSTOM LENGTH AVAILABLE UPON REQUEST****

TIE-DOWN STRAP

2" RATCHET STRAP FLAT HOOK



Part Number	Strap Width	Length	Working Load Limit	End Hook
210RFHKIT	2"	10'	3,335 LBS	Flat Hook
215RFHKIT	2"	15'	3,335 LBS	Flat Hook
220RFHKIN	2"	20'	3,335 LBS	Flat Hook
225RFHKIT	2"	25'	3,335 LBS	Flat Hook
230RFHKIN	2"	30'	3,335 LBS	Flat Hook

****CUSTOM LENGTH AVAILABLE UPON REQUEST****

CARGO STRAP



Part Number	Strap Width	Length	Working Load Limit	End Hook
220CFHKIT	2"	20'	3,335 LBS	FLAT HOOK
220CWFHKIT	2"	20'	3,335 LBS	WIRE HOOK
330CFHKIT	3"	30'	4,000 LBS	FLAT HOOK
330CDRKIT	3"	30'	4,000 LBS	D-RING
340CFHKIT	3"	40'	4,000 LBS	FLAT HOOK
340CDRKIT	3"	40'	4,000 LBS	D-RING
430CFHKIN	4"	30'	5,400 LBS	FLAT HOOK
430CDR-K	4"	30'	5,400 LBS	D-RING

****CUSTOM LENGTH AVAILABLE UPON REQUEST****

TOW STRAP WITH EYE PROTECTION



Part Number	Strap Width	PLY	Length	Break Strength
TS2120	1"	2 PLY	20'	15,000 LBS
TS2220	2"	2 PLY	20'	32,000 LBS
TS2230	2"	2 PLY	30'	32,000 LBS
TS2320	3"	2 PLY	20'	48,000 LBS
TS2330	3"	2 PLY	30'	48,000 LBS
TS2420	4"	2 PLY	20'	62,000 LBS
TS2430	4"	2 PLY	30'	62,000 LBS
TS2620	6"	2 PLY	20'	100,000 LBS
TS2630	6"	2 PLY	30'	100,000 LBS
TS2820	8"	2 PLY	20'	120,000 LBS
TS2830	8"	2 PLY	30'	120,000 LBS
TS21020	10"	2 PLY	20'	150,000 LBS
TS21030	10"	2 PLY	30'	150,000 LBS
TS21220	12"	2 PLY	20'	175,000 LBS
TS21230	12"	2 PLY	30'	175,000 LBS

****3 & 4 Ply Available, Custom Lengths****

TOW ROPE

DOUBLE BRAID NYLON WITH EYE WEAR PROTECTION



Part Number	Rope Diameter	Length	Working Load Limit	Break Strength
RDB34X20SE	3/4"	20'	10,100 LBS	20,200 LBS
RDB1X20SE	1"	20'	16,000 LBS	32,000 LBS
RDB1X25SE	1"	25'	16,000 LBS	32,000 LBS
RDB1X30SE	1"	30'	16,000 LBS	32,000 LBS
RDB114X20SE	1-1/4"	20'	26,000 LBS	52,000 LBS
RDB114X25SE	1-1/4"	25'	26,000 LBS	52,000 LBS
RDB114X30SE	1-1/4"	30'	26,000 LBS	52,000 LBS

SAFE WORKING LOAD BASED ON 2:1 Ratio

DYNEEMA SLING EYE & EYE OR TOW ROPE



Part Number	Rope Diameter	Vertical Lifting Rating	Length	Break Strength
RDYSS1X20	1"	21,605 LBS	20'	108,026 LBS
RDYSS1116X20	1-1/16"	24,912 LBS	20'	124,561 LBS
RDYSS118X20	1-1/8"	28,528 LBS	20'	142,639 LBS
RDYSS114X20	1-1/4"	32,849 LBS	20'	164,244 LBS
RDYSS138X20	1-3/8"	40,785 LBS	20'	203,927 LBS
RDYSS112X20	1-1/2"	44,533 LBS	20'	222,667 LBS
RDYSS158X20	1-5/8"	53,793 LBS	20'	268,964 LBS
RDYSS134X20	1-3/4"	64,375 LBS	20'	321,875 LBS
RDYSS2X20	2"	73,193 LBS	20'	365,967 LBS
RDYSS218X20	2-1/8"	86,421 LBS	20'	432,106 LBS
RDYSS214X20	2-1/4"	99,649 LBS	20'	498,244 LBS
RDYSS212X20	2-1/2"	112,436 LBS	20'	562,178 LBS
RDYSS258X20	2-5/8"	125,222 LBS	20'	626,112 LBS
RDYSS234X20	2-3/4"	141,537 LBS	20'	707,683 LBS
RDYSS3X20	3"	157,851 LBS	20'	789,254 LBS

(Other Sizes and Length Available on Request)

TIE DOWN CHAIN GRADE 70

High carbon steel, heat treated. Chain is zinc plated with gold chromate finish. Meets ASTM & NACM standards. Safety Ratio 4:1 Domestic chain.



CHAIN SIZE	WIRE DIAMETER	INSIDE LENGTH	INSIDE WIDTH	WEIGHT PER 100 FT	WORKING LOAD LIMIT
1/4"	0.28	0.84	0.47	76.4 LBS	3,150 LBS
5/16"	0.33	1.10	0.50	96.9 LBS	4,700 LBS
3/8"	0.39	1.38	0.60	136.5 LBS	6,600 LBS
7/16"	0.458	1.37	0.67	209 LBS	8,750 LBS
1/2"	0.53	1.56	0.73	267.0 LBS	11,300 LBS

CARGO ACCESSORIES





the Crosby[®] group



CROSBY G-209/S-209 SHACKLE

SCREW PIN ANCHOR SHACKLES



G-209 / S-209

G-209 Screw pin anchor shackles meet the performance requirements of Federal Specification RR-C-271F Type IVA, Grade A, Class 2, except for those provisions required of the contractor.

G-209 / S-209

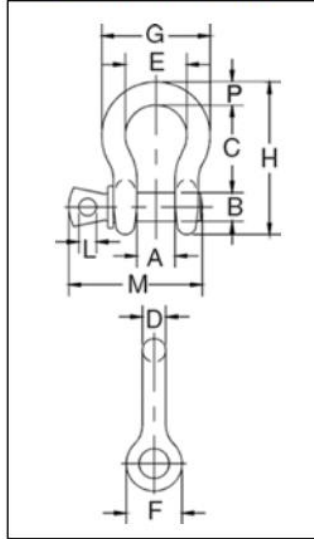

- Capacities 1/3 thru 55 metric tons, grade 6.
- Forged - Quenched and Tempered, with alloy pins.
- Working Load Limit and grade "6" permanently shown on every shackle.
- Hot Dip galvanized or Self Colored.
- Fatigue rated.
- Shackles 25t and larger are RFID EQUIPPED.
- Shackles can be furnished proof tested with certificates to designated standards, such as ABS, DNV, Lloyds, or other certification. Charges for proof testing and certification available when requested at the time of order.
 - Approved for use at -40 degree C (-40 degree F) to 204 degree C (400 degree F).
- 2t through 25t bow and screw pin are Certified to meet charpy impact testing of 42 joules (31 ft.-lbs.) min. ave. at -20 degree C (-4 degree F).
- All shackles are Quenched and Tempered and can meet DNV impact requirements of 42 joules (31 ft. lbs.) at -20 degree C (-4 degree F).
- Meets or exceeds all requirements of ASME B30.26.
- Type Approval and certification in accordance with ABS 2006 Steel Vessel Rules 1-1-17.7, and ABS Guide for Certification of Cranes.
- Crosby 2t through 25t G209 anchor shackles are type approved to DNV Certification Notes 2.7-1 -Offshore Containers. These Crosby shackles are statistical proof and impact tested. The tests are conducted by Crosby and 3.1 test certification is available upon request.
- Look for the Red Pin® . . . the mark of genuine Crosby quality.

NOMINAL SIZE (INCHES)	WORKING LOAD LIMIT	STOCK NUMBER		WEIGHT EACH (LBS)	DIMENSIONS (INCHES)							
		G-209	S-209		A	B	C	D	E	F	G	H
3/16	1/3	1018357	-	.06	.38	.25	.88	.19	.60	.56	.98	1.47
1/4	1/2	1018375	1018384	.10	.47	.31	1.13	.25	.78	.61	1.28	1.84
5/16	3/4	1018393	1018400	.18	.53	.38	1.22	.31	.84	.75	1.47	2.09
3/8	1	1018419	1018428	.31	.66	.44	1.44	.38	1.03	.91	1.78	2.49
7/16	1-1/2	1018437	1018446	.38	.75	.50	1.69	.44	1.16	1.06	2.03	2.91
1/2	2	1018455	1018464	.72	.81	.63	1.88	.50	1.31	1.19	2.31	3.28
5/8	3-1/4	1018473	1018482	1.37	1.06	.75	2.38	.63	1.69	1.50	2.94	4.19
3/4	4-3/4	1018491	1018507	2.35	1.25	.88	2.81	.75	2.00	1.81	3.50	4.97
7/8	6-1/2	1018516	1018525	3.62	1.44	1.00	3.31	.88	2.28	2.09	4.03	5.83
1	8-1/2	1018534	1018543	5.03	1.69	1.13	3.75	1.00	2.69	2.38	4.69	6.56
1-1/8	9-1/2	1018552	1018561	7.41	1.81	1.25	4.25	1.16	2.91	2.69	5.16	7.47
1-1/4	12	1018570	1018589	9.50	2.03	1.38	4.69	1.29	3.25	3.00	5.75	8.25
1-3/8	13-1/2	1018598	1018605	13.53	2.25	1.50	5.25	1.42	3.63	3.31	6.38	9.16
1-1/2	17	1018614	1018623	17.20	2.38	1.63	5.75	1.54	3.88	3.63	6.88	10.00
1-3/4	25	1018632	1018641	27.78	2.88	2.00	7.00	1.84	5.00	4.19	8.86	12.34
2	35	1018650	1018669	45.00	3.25	2.25	7.75	2.08	5.75	4.81	9.97	13.68
2-1/2	55	1018678	1018687	85.75	4.13	2.75	10.50	2.71	7.25	5.69	12.87	17.84

CROSBY G-2130/S-2130 SHACKLE

BOLT TYPE ANCHOR SHACKLES



G-2130 / S-2130

G-2130 Bolt Type Anchor shackles with thin head bolt - nut with cotter pin. Meets the performance requirements of Federal Specification RR-C-271F Type IVA, Grade A, Class 3, except for those provisions required of the contractor.

G-2130 / S-2130

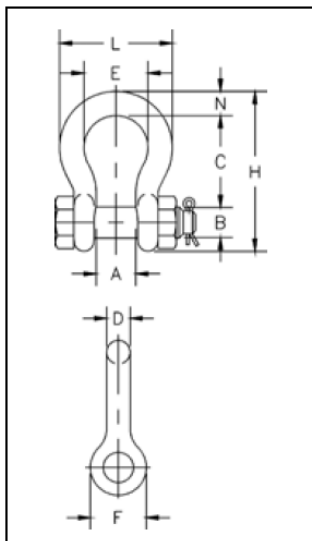

- Capacities 1/3 thru 150 metric tons, grade 6.
- Working Load Limit and grade "6" permanently shown on every shackle.
- Forged – Quenched and Tempered, with alloy pins.
- Hot Dip galvanized or Self Colored. (85, 120, and 150 metric ton shackles are all hot dip galvanized bows and the bolts are Dimetcoated® and painted red)
- Fatigue rated (1/3t - 55t).
- Shackles 25t and larger are RFID EQUIPPED.
- Approved for use at -40 degree C (-40 degree F) to 204 degree C (400 degree F).
- Meets or exceeds all requirements of ASME B30.26.
- Shackles 85 metric tons and larger are individually proof tested to 2.0 times the working load limit.
- Shackles 120 metric tons and larger are proof tested, Magnetic Particle Inspected and provided with Serialized Pin and Bow.
- Type Approval and certification in accordance with ABS 2006 Steel Vessel Rules 1-1-17.7, and ABS Guide for Certification of Cranes.
- 3.1 Certification as standard available for charpy and statistical proof test for pg 79 only up to 25 tons to DNV2.7-1 and EN13889.
- Crosby 2t through 25t G2130 anchor shackles are type approved to DNV Certification Notes 2.7-1- Offshore Containers. These Crosby shackles are statistical proof and impact tested to 42 joules (31 ft.-lbs.) min. ave. at -20 degree C (-4 degree F). The tests are conducted by Crosby and 3.1 test certification is available upon request. Refer to page 76 for Crosby COLD TUFF® shackles that meet the additional requirements of DNV rules for certification of lifting applications - Loose Gear.
- All other 2130 and all 2150 shackles can meet charpy requirements of 42 joules (31 ft.-lbs) avg at -20 degree C (-4 degree F) upon special request.
- Look for the Red Pin® . . . the mark of genuine Crosby quality.

NOMINAL SIZE (INCHES)	WORKING LOAD LIMIT	STOCK NUMBER		WEIGHT EACH (LBS)	DIMENSIONS (INCHES)							
		G-209	S-209		A	B	C	D	E	F	L	H
3/16	1/3	1019464	-	.06	.38	.25	.88	.19	.60	.56	.98	1.47
1/4	1/2	1019466	-	.11	.47	.31	1.13	.25	.78	.61	1.28	1.84
5/16	3/4	1019468	-	.22	.53	.38	1.22	.31	.84	.75	1.47	2.09
3/8	1	1019470	-	.33	.66	.44	1.44	.38	1.03	.91	1.78	2.49
7/16	1-1/2	1019471	-	.49	.75	.50	1.69	.44	1.16	1.06	2.03	2.91
1/2	2	1019472	1019481	.79	.81	.63	1.88	.50	1.31	1.19	2.31	3.28
5/8	3-1/4	1019490	1019506	1.68	1.06	.75	2.38	.63	1.69	1.50	2.94	4.19
3/4	4-3/4	1019515	1019524	2.72	1.25	.88	2.81	.75	2.00	1.81	3.50	4.97
7/8	6-1/2	1019533	1019542	3.95	1.44	1.00	3.31	.88	2.28	2.09	4.03	5.83
1	8-1/2	1019551	1019560	5.66	1.69	1.13	3.75	1.00	2.69	2.38	4.69	6.56
1-1/8	9-1/2	1019579	1019588	8.27	1.81	1.25	4.25	1.16	2.91	2.69	5.16	7.47
1-1/4	12	1019597	1019604	11.71	2.03	1.38	4.69	1.29	3.25	3.00	5.75	8.25
1-3/8	13-1/2	1019613	1019622	15.83	2.25	1.50	5.25	1.42	3.63	3.31	6.38	9.16
1-1/2	17	1019631	1019640	19.00	2.38	1.63	5.75	1.54	3.88	3.63	6.88	10.00
1-3/4	25	1019659	1019668	33.91	2.88	2.00	7.00	1.84	5.00	4.19	8.80	12.34
2	35	1019677	1019686	52.25	3.25	2.25	7.75	2.08	5.75	4.81	10.15	13.68
2-1/2	55	1019695	1019702	98.25	4.13	2.75	10.50	2.71	7.25	5.69	12.75	17.90
3	85	1019711	-	154.00	5.00	3.30	13.00	3.12	7.88	6.50	14.62	21.50
3-1/2	120	1019739	-	265.00	5.25	3.76	14.63	3.62	9.00	8.00	17.02	24.88
4	150	1019757	-	338.00	5.50	4.26	14.50	4.00	10.0	9.00	18.00	25.68

CROSBY G-209A SHACKLE



G-209A Screw pin anchor shackles meet the performance requirements of Federal Specification RR-C-271F Type IVA, Grade B, Class 2, except for those provisions required of the contractor.

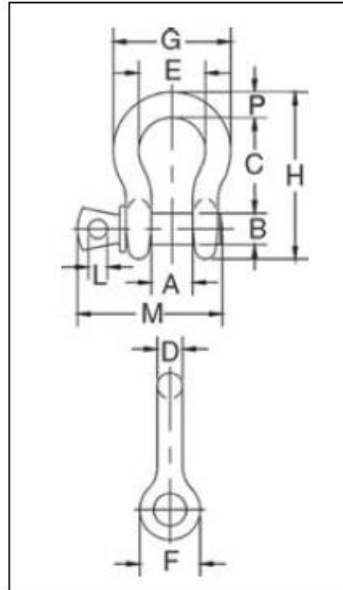

- Capacities 2 thru 21 metric tons. Meets performance requirements of Grade 8 shackles.
- Forged Alloy Steel – Quenched and Tempered, with alloy pins.
- Working Load Limit permanently shown on every shackle.
- Hot Dip Galvanized.
- Shackles can be furnished proof tested with certificates to designated standards, such as ABS, DNV, Lloyds, or other certification. Charges for proof testing and certification available when requested at the time of order.
- Approved for use at -40 degree C (-40 degree F) to 204 degree C (400 degree F).
- Meets or exceeds all requirements of ASME B30.26 including identification, ductility, design factor, proof load and temperature requirements. Importantly, these shackles meet other critical performance requirements including fatigue life, impact properties and material traceability, not addressed by ASME B30.26.

NOMINAL SIZE (INCHES)	WORKING LOAD LIMIT	STOCK NUMBER	WEIGHT EACH (LBS)	DIMENSIONS (INCHES)							
				A	B	C	D	E	F	G	H
3/8	2	1017450	.31	.66	.44	1.44	.38	1.03	.91	1.78	2.49
7/16	2-2/3	1017472	.38	.75	.50	1.69	.44	1.16	1.06	2.03	2.91
1/2	3-1/3	1017494	.63	.81	.63	1.88	.50	1.31	1.19	2.31	3.28
5/8	5	1017516	1.38	1.06	.75	2.38	.63	1.69	1.50	2.94	4.19
3/4	7	1017538	2.35	1.25	.88	2.81	.75	2.00	1.81	3.50	4.97
7/8	9-1/2	1017560	3.61	1.44	1.00	3.31	.88	2.28	2.09	4.03	5.83
1	12-1/2	1017582	5.32	1.69	1.13	3.75	1.00	2.69	2.38	4.69	6.56
1-1/8	15	1017604	7.25	1.81	1.25	4.25	1.16	2.91	2.69	5.16	7.47
1-1/4	18	1017626	9.88	2.03	1.38	4.69	1.29	3.25	3.00	5.75	8.25
1-3/8	21	1017648	13.25	2.25	1.50	5.25	1.42	3.63	3.31	6.38	9.16

CROSBY G-2140/S-2140 SHACKLE

**G-2140 / S-2140
ALLOY
BOLT TYPE
ANCHOR
SHACKLES**

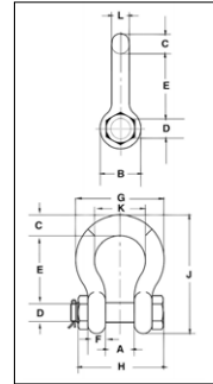

Quenched and Tempered. Alloy bows, Alloy bolts. Forged Alloy Steel 30 thru 200 metric tons and Cast Alloy Steel 250 thru 400 metric tons. Meets performance requirements of Grade 8 shackles. Working Load Limit is permanently shown on every shackle. 30, 40, 55, and 85 metric ton shackle bows are available galvanized or self colored with pins that are galvanized and painted red. 120, 150, 175 metric ton shackle bows are hot-dip galvanized; pins are Dimetcoated® and painted red. • 200, 250, 300 and 400 metric ton shackle bows are Dimetcoated®; pins are Dimetcoated® and painted red. All sizes are RFID EQUIPPED. Approved for use at -40 degree C (-40 degree F) to 204 degree C (400 degree F). Shackles are Quenched and Tempered and can meet DNV impact requirements of 42 joules (31 ft-lbs.) at -20 degree C (-4 degree F). All sizes are individually proof tested to 2.0 times the Working Load Limit. Shackles 200 metric tons and larger are provided as follows. Serialized Pin and Bow Material Certification (Chemical) Magnetic Particle Inspected. Certification must be requested at time of order. Meets or exceeds all requirements of ASME B30.26 including identification, ductility, design factor, proof load and temperature requirements. Importantly, these shackles meet other critical performance requirements including fatigue life, impact properties and material traceability, not addressed by ASME B30.26.

NOMINAL SIZE (INCHES)	WORKING LOAD LIMIT	STOCK NUMBER		WEIGHT EACH (LBS)	DIMENSIONS (INCHES)							
		G-2140	S-2140		A	B	C	D	E	F	G	H
3/8	2	1021015	-	0.33	0.66	0.91	0.38	0.44	1.44	0.38	1.78	2.17
7/16	2-2/3	1021020	-	0.49	0.75	1.06	0.44	0.50	1.68	0.41	2.03	2.51
1/2	3-1/3	1021029	-	0.79	0.81	1.19	0.50	0.64	1.88	0.46	2.31	2.80
5/8	5	1021038	-	1.68	1.06	1.50	0.69	0.77	2.38	0.58	2.94	3.56
3/4	7	1021047	-	2.72	1.25	1.81	0.81	0.89	2.81	0.69	3.50	4.15
7/8	9-1/2	1021056	-	3.95	1.44	2.09	0.97	1.02	3.31	0.81	4.03	4.82
1	12-1/2	1021065	-	5.66	1.68	2.38	1.06	1.15	3.75	0.92	4.69	5.39
1-1/8	15	1021074	-	8.27	1.81	2.69	1.25	1.25	4.25	1.04	5.16	5.90
1-1/4	18	1021083	-	11.70	2.03	3.00	1.38	1.40	4.69	1.16	5.75	6.69
1-3/8	21	1021092	-	15.80	2.25	3.31	1.50	1.53	5.25	1.28	6.38	7.21
1-1/2	30	1021110	1021129	18.80	2.38	3.62	1.62	1.63	5.75	1.39	6.88	7.73
1-3/4	40	1021138	1021147	33.80	2.88	4.19	2.25	2.00	7.00	1.75	8.81	9.33
2	55	1021156	1021165	49.90	3.25	4.81	2.40	2.25	7.75	2.00	10.16	10.41
2-1/2	85	1021174	1021183	103	4.12	5.81	3.12	2.75	10.5	2.62	12.75	13.58
3	120	1021192	-	162	5.00	6.5	3.63	3.25	13.00	3.00	14.62	15.13
3-1/2	150	1021218	-	268	5.25	8.0	4.38	3.75	14.63	3.75	17.02	17.62
4	175	1021236	-	332	5.50	9.0	4.56	4.25	14.50	4.00	18.00	20.37
4-3/4	200E	1021422	-	452	7.25	10.5	5.00	4.75	15.19	4.58	20.84	23.11
5	250E	1021442	-	594	8.50	12.0	5.63	5.00	18.50	4.48	23.63	24.28
6	300E	1021460	-	791	8.38	13.0	6.06	6.00	18.72	4.89	24.76	24.45
7	400	1021478	-	1200	8.25	14.0	7.25	7.00	22.50	6.50	26.00	28.68

CROSBY G-2160/S-2160 WIDE BODY SHACKLE



G-2160/ S-2160



G-2160E

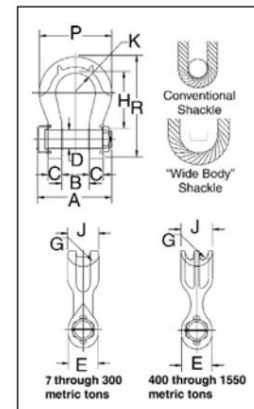

All sizes Quenched and Tempered for maximum strength. Forged alloy steel from 7 to 300 metric tons. Cast alloy steel from 400 to 1550 metric tons. Sizes 300 metric tons and smaller are proof tested to 2 times the Working Load Limit. Sizes 400 metric tons and larger are tested to 1.33 times Working Load Limit. All ratings are in metric tons, embossed on side of bow. G-2160, (7-55t), are Hot Dip Galvanized and pins are painted red. G-2160, (75t and larger), shackles are furnished Dimetcoated, and then painted red. S-2160 bows and pins are painted red. Shackles, 30t and larger, are RFID EQUIPPED. Can be used to connect HIGH STRENGTH Synthetic Web Slings, HIGH STRENGTH Synthetic Round Slings or Wire Rope Slings. Increase in shackle bow radius provides minimum 58% gain in sling bearing surface and eliminates need for a thimble. Pin is non-rotating, with weld-on handles for easier use (75t and larger). Approved for use at -40 degree C (-40 degree F) to 204 degree C (400 degree F). All 2160 shackles are individually proof tested and magnetic particle inspected. Crosby certification available at time of order. Shackles requiring ABS, Lloyds and other certifications are available upon special request and must be specified at time of order.

BODY DIAMETER (INCHES)	WORKING LOAD LIMIT	STOCK NUMBER		WEIGHT EACH (LBS)	DIMENSIONS (INCHES)						
		G-2160	S-2160		A	B	D	H	J	P	R
2.1	7	1021256	1021548	4.0	4.14	1.25	.88	3.56	1.60	4.10	5.87
2.4	12.5	1021265	1021557	8.80	5.38	1.69	1.13	4.63	2.13	5.51	7.63
2.8	18	1021274	1021566	14.90	6.69	2.03	1.38	5.81	2.50	6.76	9.38
4.1	30	1021283	1021575	26.50	7.69	2.37	1.63	6.94	3.13	8.50	11.38
3.6	40	1021285	1021584	46.00	9.28	2.88	2.00	8.06	3.75	10.62	13.62
4.3	55	1021287	1021593	68.00	10.36	3.25	2.25	9.36	4.50	12.26	15.63
5	75	1021290	-	99.00	14.37	4.13	2.75	11.53	4.75	12.64	18.66
14.3	400	1021334	-	1130	30.27	8.66	6.30	22.64	12.60	27.17	38.78
14.8	500	1021343	-	1440	33.35	9.84	7.09	24.81	13.39	31.10	42.72
20.3	600	1021352	-	1995	36.02	10.83	7.87	27.56	14.57	34.06	47.24
16.6	700	1021361	-	2415	38.91	11.81	8.46	28.94	15.75	37.01	50.18
18.0	800	1021254	-	2880	41.66	12.80	9.06	29.53	16.54	38.39	52.09
22.4	900	1021389	-	3628	43.73	13.78	9.84	29.82	17.32	40.35	54.04
19.3	1000	1021370	-	4155	45.98	14.96	10.63	29.92	18.11	42.32	55.31
24.4	1250	1021272	-	5320	49.86	16.93	11.81	36.61	20.87	46.26	65.35
27.3	1550	1021281	-	8302	54.89	18.31	12.60	42.32	22.82	49.41	73.43
6.8	125E	1021309	-	178	16.75	5.12	3.15	14.36	5.91	15.47	23.00
9.5	200E	1021320	-	401	19.76	5.91	8.41	18.90	8.63	20.47	30.44
11.4	300E	1021330	-	777	23.05	7.38	10.50	23.63	10.38	23.83	37.51

CROSBY S-252 BOLT TYPE SLING SHACKLE

**S-252
BOLT TYPE
SLING
SHACKLE**

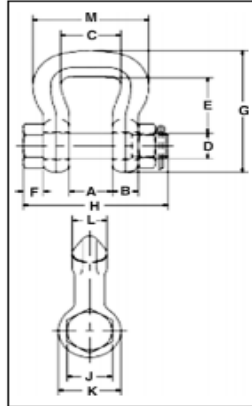

Shackles available in size 3-1/4 to 50 metric tons.

All Alloy construction. Design factor of 5 to 1.

Each shackle has a Product Identification Code (PIC) for material traceability along with a Working Load Limit and the name Crosby forged into it.

Increased radius of bow gives wider sling bearing surface resulting in an increased area for load distribution, thus:

Increasing Synthetic Sling efficiency as compared to standard anchor and chain shackle bows and conventional hooks. This allows 100% of the slings rated Working Load Limit to be achieved.

Allows better load distribution on internal fibers.

Meets or exceeds all requirements of ASME B30.26 including identification, ductility, design factor, proof load and temperature requirements. Importantly, these shackles meet other critical performance requirements including fatigue life, impact properties and material traceability, not addressed by ASME B30.26.

Shackles available in both a Screw Pin and Bolt, Nut and cotter pin configuration.

Bolt (Pin) has a larger diameter that provides better load distribution.

WEB SLING EYE WIDTH (INCHES)	ROUND SLING SIZE	WORKING LOAD LIMIT	S-252 STOCK NUMBER	WEIGHT EACH (LBS)	DIMENSIONS (INCHES)							
					A	B	C	D	E	F	G	H
1	1 & 2	3-1/4	1020485	1.4	1.06	.58	1.38	.75	1.50	.44	3.38	3.68
1.5	3 & 4	6-1/2	1020496	2.4	1.25	.75	1.75	.88	1.88	.50	4.15	4.25
2	5 & 6	8-3/4	1020507	4.1	1.38	.88	2.25	1.00	2.81	.56	5.50	4.72
3	7 & 8	12-1/2	1020518	8	1.62	1.12	3.25	1.25	3.06	.75	6.34	5.88
4	9 & 10	20-1/2	1020529	16.9	2.12	1.38	4.50	1.50	5.25	.88	9.45	7.19
5	11 & 12	35	1020540	35	2.50	1.75	5.50	2.00	6.34	1.12	11.50	9.31
6	13	50	1020551	57.5	3.00	2.12	6.50	2.25	7.70	1.25	13.75	10.38

* Maximum Proof Load is 2.5 times the Working Load Limit. Minimum Ultimate strength is 5 times the Working Load Limit.

Crosby Sling Saver hardware meets the requirements for minimum stock diameter or thickness, and effective contact width shown in the Recommended Standards Specification for Synthetic Polyester Round Slings by the Web Sling & Tie Down Association. WSTDA-RS1 (revised 2010)

CROSBY S-253 SCREW PIN SLING SHACKLE

S-253 SCREW PIN SLING SHACKLE

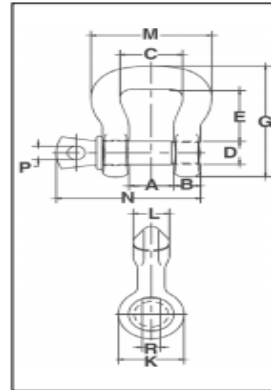

Shackles available in size 3-1/4 to 50 metric tons.

All Alloy construction. Design factor of 5 to 1.

Each shackle has a Product Identification Code (PIC) for material traceability along with a Working Load Limit and the name Crosby forged into it.

Increased radius of bow gives wider sling bearing surface resulting in an increased area for load distribution, thus:

Increasing Synthetic Sling efficiency as compared to standard anchor and chain shackle bows and conventional hooks. This allows 100% of the slings rated Working Load Limit to be achieved.

Allows better load distribution on internal fibers.

Meets or exceeds all requirements of ASME B30.26 including identification, ductility, design factor, proof load and temperature requirements. Importantly, these shackles meet other critical performance requirements including fatigue life, impact properties and material traceability, not addressed by ASME B30.26.

Shackles available in both a Screw Pin and Bolt, Nut and cotter pin configuration.

WEB SLING EYE WIDTH (INCHES)	ROUND SLING SIZE	WORKING LOAD LIMIT	S-253 STOCK NUMBER	WEIGHT EACH (LBS)	DIMENSIONS (INCHES)							
					A	B	C	D	E	G	K	L
1	1 & 2	3-1/4	1020575	1.4	.88	.62	1.38	.75	1.50	3.38	1.50	.75
1.5	3 & 4	6-1/2	1020584	2.2	1.25	.75	1.75	.88	1.88	4.15	1.81	1.00
2	5 & 6	8-3/4	1020593	3.8	1.38	.88	2.25	1.00	2.81	5.50	2.09	1.12
3	7 & 8	12-1/2	1020602	7.3	1.62	1.12	3.25	1.25	3.06	6.34	2.62	1.38
4	9 & 10	20-1/2	1020611	15.2	2.12	1.38	4.50	1.50	5.25	9.45	3.12	1.75
5	11 & 12	35	1020620	30.8	3.50	1.75	5.50	2.00	6.34	11.50	4.19	2.25
6	13	50	1020629	52	3.00	2.12	6.50	2.25	7.70	13.75	4.75	2.75

* Maximum Proof Load is 2.5 times the Working Load Limit. Minimum Ultimate strength is 5 times the Working Load Limit.

Crosby Sling Saver hardware meets the requirements for minimum stock diameter or thickness, and effective contact width shown in the Recommended Standards Specification for Synthetic Polyester Round Slings by the Web Sling & Tie Down Association. WSTDA-RS1 (revised 2010)

SCREW PIN ANCHOR SHACKLE “YELLOW PIN”

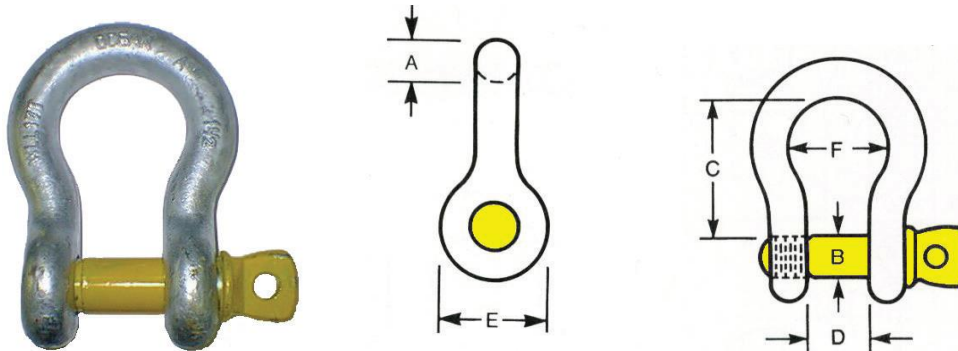

Screw Pin Anchor Bow Shackle, “Yellow Pin” - (6:1 WLL) Galvanized, dimensions approximate.

® Trademark - Yellow Pin Shackle - Registration Number - ® TMA 862,758

Federal Specification RR-C-271D, Type IVA, Grade A, Class 2.

Forged - Quenched and Tempered, Alloy Pins.

To assure traceability, “Yellow Pin” shackles are embossed to exceed ASME B30.26 requirements.

•“OCEAN”

•Size

•Alloy Pin ID

•WLL (Working Load Limit)

•Production Code - Traceable to certificate & material

•Powder Coated “Yellow Pin” for instant recognition

NOMINAL SIZE (INCHES)	WORKING LOAD LIMIT TONNES	STOCK NUMBER GALVANIZED	WEIGHT EACH (LBS)	DIMENSIONS (INCHES)					
				A	B	C	D	E	F
3/16	1/3	C1018357Y	.06	0.19	0.25	0.88	0.38	0.56	0.60
1/4	1/2	C1018384Y	.10	0.25	0.31	1.13	0.47	0.61	0.78
5/16	3/4	C1018400Y	.18	0.31	0.38	1.22	0.53	0.75	0.84
3/8	1	C1018428Y	.31	0.38	0.44	1.44	0.66	0.91	1.03
7/16	1-1/2	C1018446Y	.38	0.44	0.50	1.69	0.75	1.06	1.16
1/2	2	C1018464Y	.72	0.50	0.63	1.88	0.81	1.19	1.31
5/8	3-1/4	C1018482Y	1.37	0.63	0.75	2.38	1.06	1.50	1.69
3/4	4-3/4	C1018507Y	2.35	0.75	0.88	2.81	1.25	1.81	2.00
7/8	6-1/2	C1018525Y	3.62	0.88	1.00	3.31	1.44	2.09	2.28
1	8-1/2	C1018543Y	5.03	1.00	1.13	3.75	1.69	2.38	2.69
1-1/8	9-1/2	C1018561Y	7.41	1.16	1.25	4.25	1.81	2.69	2.91
1-1/4	12	C1018589Y	9.50	1.29	1.38	4.69	2.03	3.00	3.25
1-3/8	13-1/2	C1018605Y	13.53	1.42	1.50	5.25	2.25	3.31	3.63
1-1/2	17	C1018623Y	17.20	1.54	1.63	5.75	2.38	3.63	3.88
1-3/4	25	C1018641Y	27.78	1.84	2.00	7.00	2.88	4.19	5.00
2	35	C1018669Y	45.00	2.08	2.25	7.75	3.25	4.81	5.75
2-1/2	55	C1018687Y	85.75	2.71	2.75	10.50	4.13	5.69	7.25

BOLT TYPE ANCHOR SHACKLE “YELLOW PIN”

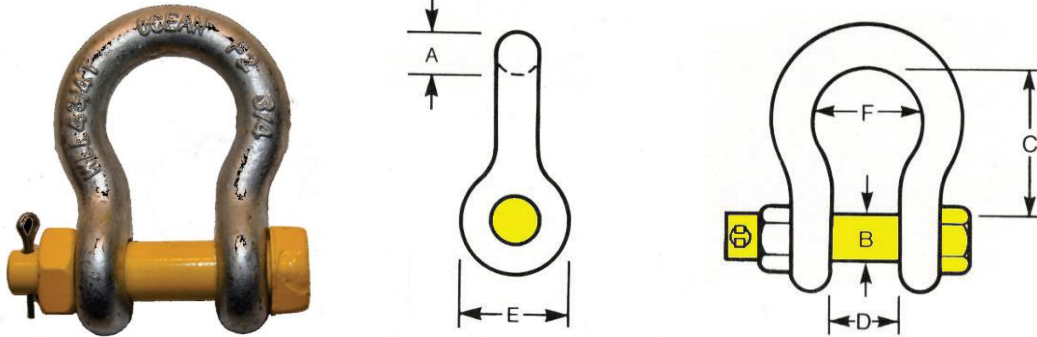

Safety Anchor Bow Shackle, “Yellow Pin Shackles” - (6:1 WLL) Galvanized, dimensions approximate.

® Trademark – Yellow Pin Shackle – Registration Number - ® TMA 862,758

Federal Specification RR-C-271D, Type IVA, Grade A, Class 3.

Forged – Quenched and Tempered, Alloy Pins.

To assure traceability, “Yellow Pin” shackles are embossed to exceed ASME B30.26 requirements.

- “OCEAN”
- Size
- Alloy Pin ID
- WLL (Working Load Limit)
- Production Code – Traceable to certificate & material
- Powder Coated “Yellow Pin” for instant recognition

NOMINAL SIZE (INCHES)	WORKING LOAD LIMIT TONNES	STOCK NUMBER GALVANIZED	WEIGHT EACH (LBS)	DIMENSIONS (INCHES)					
				A	B	C	D	E	F
1/4	1/2	C1019466Y	.06	0.25	0.31	1.13	0.47	0.61	0.78
5/16	3/4	C1019468Y	.10	0.31	0.38	1.22	0.53	0.75	0.84
3/8	1	C1019470Y	.18	0.38	0.44	1.44	0.66	0.91	1.03
7/16	1-1/2	C1019471Y	.31	0.44	0.50	1.69	0.75	1.06	1.16
1/2	2	C1019472Y	.38	0.50	0.63	1.88	0.81	1.19	1.31
5/8	3-1/4	C1019490Y	.72	0.63	0.75	2.38	1.06	1.50	1.69
3/4	4-3/4	C1019515Y	1.37	0.75	0.86	2.81	1.25	1.81	2.00
7/8	6-1/2	C1019533Y	2.35	0.88	1.00	3.31	1.44	2.09	2.28
1	8-1/2	C1019551Y	3.62	1.00	1.13	3.75	1.69	2.38	2.69
1-1/8	9-1/2	C1019579Y	5.03	1.13	1.25	4.25	1.81	2.69	2.91
1-1/4	12	C1019597Y	7.41	1.25	1.38	4.69	2.03	3.00	3.25
1-3/8	13-1/2	C1019613Y	9.50	1.38	1.50	5.25	2.25	3.31	3.63
1-1/2	17	C1019631Y	13.53	1.50	1.63	5.75	2.38	3.63	3.88
1-3/4	25	C1019659Y	17.20	1.75	2.00	7.00	2.88	4.19	5.00
2	35	C1019677Y	27.78	2.00	2.25	7.75	3.25	4.81	5.75

SCREW PIN ANCHOR SHACKLE “GOLD PIN”

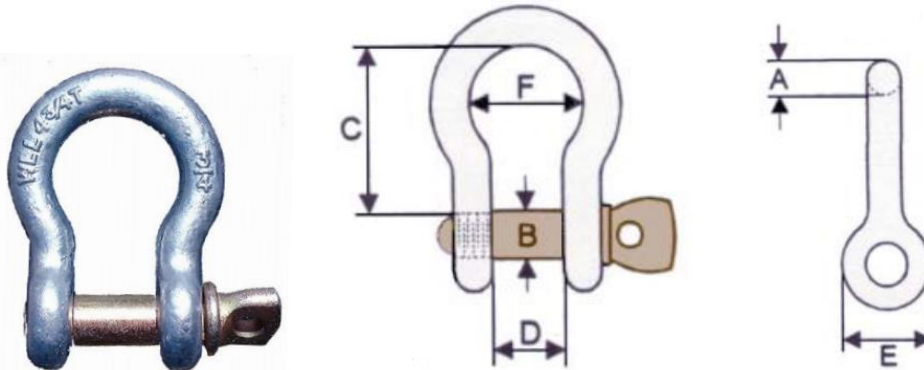

“GOLD PIN” Meet the performance requirements of U.S. Fed. Spec. RR-C-271D, Type 4A, Grade A, Class 2. Heat treated carbon steel bows, quenched and tempered with Alloy pins. Hot dipped galvanized. Metallic coating of shackle pins allows for closer thread tolerances than possible for shackles with an extra layer of paint. Design factor 6:1. To assure total traceability and to exceed the requirements of ASME B30.26 ‘Golden Pin’ shackles bodies are embossed with: Vanguard, WLL (working load limit), Size Trace Code ‘Golden Pin’ shackles pins are stamped with: Vanguard I.D. (VGD®), Alloy Pin I.D. WLL (HS), Yellow chromated for instant recognition, Trace Code

NOMINAL SIZE (INCHES)	WORKING LOAD LIMIT TON	STOCK NUMBER GALVANIZED	WEIGHT EACH (LBS)	DIMENSIONS (INCHES)					
				A	B	C	D	E	F
3/16	1/3	C1018357V	0.06	0.19	0.25	0.93	0.39	0.59	0.64
1/4	1/2	C1018375V	0.12	0.25	0.31	1.14	0.49	0.70	0.75
5/16	3/4	C1018393V	0.18	0.31	0.38	1.23	0.53	0.83	0.80
3/8	1	C1018419V	0.32	0.38	0.44	1.41	0.69	0.98	1.01
7/16	1-1/2	C1018437V	0.45	0.44	0.50	1.70	0.72	1.06	1.13
1/2	2	C1018455V	0.68	0.50	0.63	1.83	0.83	1.18	1.25
5/8	3-1/4	C1018473V	1.36	0.63	0.75	2.36	1.06	1.55	1.67
3/4	4-3/4	C1018491V	2.24	0.75	0.88	2.76	1.24	1.78	1.98
7/8	6-1/2	C1018516V	3.50	0.88	1.00	3.29	1.42	2.09	2.25
1	8-1/2	C1018534V	5.00	1.00	1.13	3.69	1.75	2.35	2.66
1-1/8	9-1/2	C1018552V	7.65	1.16	1.25	4.23	1.80	2.71	2.79
1-1/4	12	C1018570V	10.40	1.29	1.38	4.63	2.12	3.01	3.15
1-3/8	13-1/2	C1018598V	13.80	1.42	1.50	5.17	2.30	3.32	3.60
1-1/2	17	C1018614V	17.90	1.54	1.63	5.67	2.39	3.63	3.85
1-3/4	25	C1018632V	27.90	1.84	2.00	7.06	2.96	4.23	4.99
2	35	C1018650V	42.70	2.08	2.25	7.75	3.31	5.11	5.59
2-1/2	55	C1018678V	85.00	2.71	2.75	10.25	4.00	5.75	7.00

BOLT TYPE ANCHOR SHACKLE “GOLD PIN”

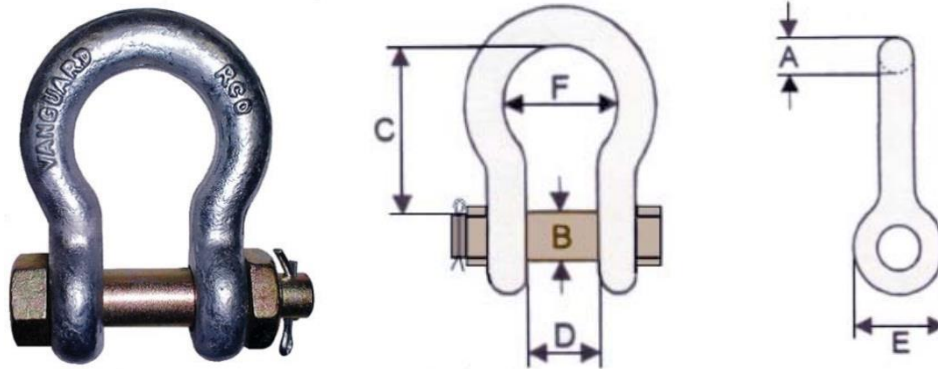

“GOLD PIN” Meet the performance requirements of U.S. Fed. Spec. RR-C-271D, Type 4A, Grade A, Class 3. Heat treated carbon steel bows, quenched and tempered with Alloy pins. Hot dipped galvanized. Metallic coating of shackle pins allows for closer thread tolerances than possible for shackles with an extra layer of paint. Design factor 6:1. To assure total traceability and to exceed the requirements of ASME B30.26 ‘Golden Pin’ shackles bodies are embossed with: Vanguard, WLL (working load limit), Size Trace Code ‘Golden Pin’ shackles pins are stamped with: Vanguard I.D. (VGD®), Alloy Pin I.D. WLL (HS), Yellow chromated for instant recognition, Trace Code

NOMINAL SIZE (INCHES)	WORKING LOAD LIMIT TON	STOCK NUMBER GALVANIZED	WEIGHT EACH (LBS)	DIMENSIONS (INCHES)					
				A	B	C	D	E	F
1/4	1/2	C1018375V	0.13	0.25	0.31	1.14	0.50	0.67	0.77
5/16	3/4	C1018393V	0.21	0.31	0.38	1.22	0.54	0.83	0.83
3/8	1	C1018419V	0.36	0.38	0.44	1.41	0.66	1.00	0.99
7/16	1-1/2	C1018437V	0.47	0.44	0.50	1.72	0.75	1.03	1.12
1/2	2	C1018455V	0.80	0.50	0.63	1.87	0.84	1.19	1.16
5/8	3-1/4	C1018473V	1.61	0.63	0.75	2.38	1.06	1.58	1.68
3/4	4-3/4	C1018491V	2.45	0.75	0.88	2.82	1.27	1.80	1.99
7/8	6-1/2	C1018516V	3.85	0.88	1.00	3.33	1.44	2.09	2.27
1	8-1/2	C1018534V	5.65	1.00	1.13	3.75	1.72	2.38	2.68
1-1/8	9-1/2	C1018552V	8.52	1.16	1.25	4.21	1.89	2.72	2.91
1-1/4	12	C1018570V	11.10	1.29	1.38	4.67	2.24	2.98	3.20
1-3/8	13-1/2	C1018598V	14.88	1.42	1.50	5.25	2.51	3.32	3.62
1-1/2	17	C1018614V	19.30	1.54	1.63	5.70	2.68	3.60	3.82
1-3/4	25	C1018632V	30.45	1.84	2.00	7.00	3.07	4.24	4.65
2	35	C1018650V	46.63	2.08	2.25	7.85	3.25	5.05	5.77

SCREW PIN CHAIN SHACKLE "GOLD PIN"

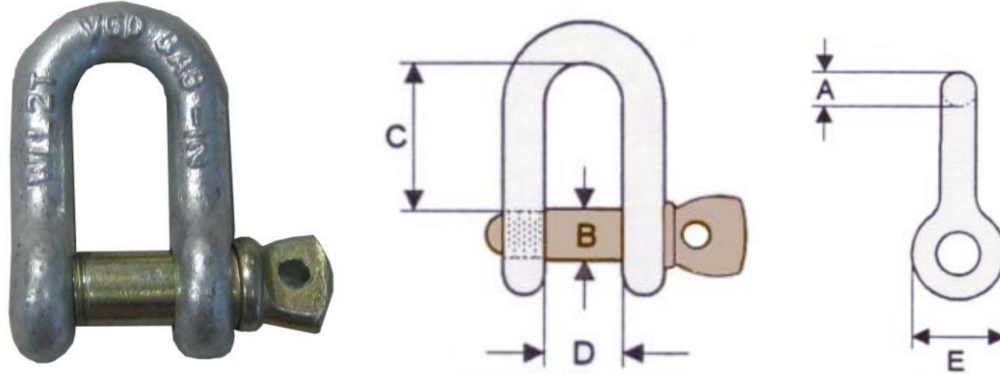

"GOLD PIN" Meet the performance requirements of U.S. Fed. Spec. RR-C-271D, Type 4A, Grade A, Class 2. Heat treated carbon steel bows, quenched and tempered with Alloy pins. Hot dipped galvanized. Metallic coating of shackle pins allows for closer tolerances than possible for shackles with an extra layer of paint. Design factor 6:1. To assure total traceability and to exceed the requirements of ASME B30.26 'Golden Pin' shackles bodies are embossed with: Vanguard, WLL (working load limit), Size Trace Code 'Golden Pin' shackles pins are stamped with: Vanguard I.D. (VGD®), Alloy Pin I.D. WLL (HS), Yellow chromated for instant recognition, Trace Code

NOMINAL SIZE (INCHES)	WORKING LOAD LIMIT TON	STOCK NUMBER GALVANIZED	WEIGHT EACH (LBS)	DIMENSIONS (INCHES)				
				A	B	C	D	E
1/4	1/2	C1018375V	0.12	0.25	0.31	0.83	0.47	0.71
5/16	3/4	C1018393V	0.18	0.31	0.38	0.98	0.47	0.75
3/8	1	C1018419V	0.32	0.38	0.44	1.22	0.63	0.96
7/16	1-1/2	C1018437V	0.45	0.44	0.50	1.50	0.75	1.06
1/2	2	C1018455V	0.68	0.50	0.63	1.61	0.83	1.22
5/8	3-1/4	C1018473V	1.36	0.63	0.75	2.01	1.10	1.57
3/4	4-3/4	C1018491V	2.24	0.75	0.88	2.41	1.25	1.81
7/8	6-1/2	C1018516V	3.50	0.88	1.00	2.80	1.42	2.13
1	8-1/2	C1018534V	5.00	1.00	1.13	3.15	1.77	2.36
1-1/8	9-1/2	C1018552V	7.65	1.16	1.25	3.50	1.85	2.69
1-1/4	12	C1018570V	10.40	1.29	1.38	3.97	2.05	3.00
1-1/2	17	C1018614V	17.90	1.54	1.63	4.80	2.39	3.68
2	35	C1018650V	42.70	2.08	2.25	6.75	3.25	5.00

STAINLESS SCREW PIN ANCHOR SHACKLE

NOMINAL SIZE (INCHES)	WORKING LOAD LIMIT TON	STOCK NUMBER GALVANIZED	WEIGHT EACH (LBS)	DIMENSIONS (INCHES)					
				A	B	C	D	E	F
3/16	1/3	C1018357V	0.06	0.19	0.25	0.93	0.39	0.59	0.64
1/4	1/2	C1018375V	0.12	0.25	0.31	1.14	0.49	0.70	0.75
5/16	3/4	C1018393V	0.18	0.31	0.38	1.23	0.53	0.83	0.80
3/8	1	C1018419V	0.32	0.38	0.44	1.41	0.69	0.98	1.01
7/16	1-1/2	C1018437V	0.45	0.44	0.50	1.70	0.72	1.06	1.13
1/2	2	C1018455V	0.68	0.50	0.63	1.83	0.83	1.18	1.25
5/8	3-1/4	C1018473V	1.36	0.63	0.75	2.36	1.06	1.55	1.67
3/4	4-3/4	C1018491V	2.24	0.75	0.88	2.76	1.24	1.78	1.98
7/8	6-1/2	C1018516V	3.50	0.88	1.00	3.29	1.42	2.09	2.25
1	8-1/2	C1018534V	5.00	1.00	1.13	3.69	1.75	2.35	2.66
1-1/8	9-1/2	C1018552V	7.65	1.16	1.25	4.23	1.80	2.71	2.79
1-1/4	12	C1018570V	10.40	1.29	1.38	4.63	2.12	3.01	3.15
1-3/8	13-1/2	C1018598V	13.80	1.42	1.50	5.17	2.30	3.32	3.60
1-1/2	17	C1018614V	17.90	1.54	1.63	5.67	2.39	3.63	3.85
1-3/4	25	C1018632V	27.90	1.84	2.00	7.06	2.96	4.23	4.99
2	35	C1018650V	42.70	2.08	2.25	7.75	3.31	5.11	5.59
2-1/2	55	C1018678V	85.00	2.71	2.75	10.25	4.00	5.75	7.00

CROSBY S-320 & S-320N EYE HOOKS



S-320
EYE HOOK

L-320N
EYE HOOK

All Crosby 320 Eye Hoist Hooks incorporate the following features:

- The most complete line of Eye hoist hooks.
- Available in carbon steel and alloy steel.
- Designed with a 5:1 Design Factor for (Carbon Steel); 4.5:1 Design Factor for 30t - 60t(Alloy Steel).
- Eye hooks are load rated.
- Proper design, careful forging and precision controlled quenched and tempering give maximum strength without excessive weight and bulk.
- Every Crosby Eye Hook has a pre-drilled cam which can be equipped with a latch. Even years after purchase of the original hook, latch assemblies can be added.
- Chemical analysis and tensile tests performed on each PIC to verify chemistry and mechanical properties.
- Type Approval and certification in accordance with ABS 2007 Steel Vessel Rules 1-1-17.7, and ABS Guide for Certification of Cranes.
- Hoist hooks incorporate two types of strategically placed markings forged into the product which address two (2) QUIC-CHECK® features:
 - Deformation Indicators and Angle Indicators

WORKING LOAD LIMIT TON		HOOK ID	EYE HOOK PART NUMBER				WEIGHT EACH	REPLACEMENT LATCH KITS	
CARBON	ALLOY	CODE	S-320N	L-320C	S-320A	L-320A	LBS	S-4320	SS-4055
3/4	1	† D	1022200	1022205	1022375	1022380	0.61	1096325	-
1	1-1/2	† F	1022211	1022216	1022386	1022391	0.89	1096374	-
1-1/2	2	† G	1022222	1022227	1022397	1022402	1.44	1096421	-
2	3	† H	1022233	1022238	1022406	1022413	2.07	1096468	-
3	5	† I	1022244	1022246	1022419	1022424	4.30	1096515	-
5	7	† J	1022255	1022260	1022430	1022435	8.30	1096562	-
7-1/2	11	† K	1022264	1022271	1022441	1022446	15.00	1096609	-
10	15	† L	1022277	1022282	1022452	1022457	20.77	1096657	-
15	22	† N	1022288	1022293	1022465	1022468	39.50	1096704	-
20	30	O	1023289	1022302	1023546	1022477	60.00	-	1090161
25	37	P	1023305	-	1023564	-	105.00	-	1090189
30	45	S	1023323	-	1023582	-	148.00	-	1090189
40	60	T	1023341	-	1023608	-	228.00	-	1090205

*Eye Hooks (3/4 TC - 22TA), Proof load is 2 times Working Load Limit. Eye Hooks (20 TC - 60TA). All carbon hooks-average straightening load (ultimate load) is 5 times Working Load Limit.

Alloy eye hooks 1 ton through 22 ton-average straightening load (ultimate load) is 5 times Working Load Limit. Alloy eye hooks 30 tons through 60 tons-average straightening load (ultimate load) is 4.5 times Working Load Limit. † style hook.

